

C-HOOK DRAWINGS FOR THE PROJECT LOCATED AT: 534 WEST 42ND STREET NEW YORK, NY 10036

TYPICAL SUSPENDED SCAFFOLD NOTES:

- *ALL TIEBACKS AND LIFELINES ARE INDEPENDENTLY SECURED TO ANCHOR POINTS, (BULKHEAD STRUCTURE, STEEL DUNNAGE, OR OPPOSITE PARAPETS).
- *TIEBACKS, LIFELINES & WIRE ROPES WRAPPED AROUND BULKHEADS, CONCRETE OR MASONRY, OR STEEL DUNNAGE ARE SEPARATE INDEPENDENT LINES, DOUBLE LOOPED AROUND STRUCTURE OR DUNNAGE.
- *TIEBACKS, LIFELINES AND WIRE ROPES ARE TO BE PROTECTED FROM ALL SHARP CORNERS, ROUGH EDGES AND BENDS (NOT SHOWN FOR CLARITY).
- *PLATFORM IS EQUIPPED WITH STANDARD RAILINGS, TOEBOARD. MAXIMUM ON TWO (2) WORKERS PER PLATFORM.
- *ENGINEER AND HS DESIGN STUDIO LLC HAVE NO RESPONSIBILITIES FOR INSPECTION OR EQUIPMENT INSTALLATION OR USAGE.
- *TIEBACK - 5/16" WIRE ROPE WITH THREE (3) FIST GRIPS; SAFETY LINE - 5/8" NYLON BLEND ROPE WITH BOWLINE KNOT.
- *ADJACENT BUILDING ROOFS: RESTRICT ACCESS OR PROVIDE ROOF PROTECTION PER NYC BUILDING CODE; COURTYARDS: RESTRICT ACCESS OR PROVIDE OVERHEAD PROTECTION.
- *ANY VARIATION OF TYPICAL TIEBACK DETAILS OR STEEL DUNNAGE DETAILS MAY BE USED AS NEEDED IN THE FIELD, AS LONG AS INSTALL CONFORMS TO ALL OSHA, NYC DOB 2014 BC SECTION 3314, MANUFACTURER SPECIFICATIONS & ANY OTHER LOCAL REGULATIONS.
- *ANY VARIATION OF THE TYPICAL OUTRIGGER BEAM ELEVATION DETAILS MAY BE USED AS NEEDED IN THE FIELD UNLESS OTHERWISE NOTED ON PLAN VIEW DRAWINGS.
- *SUPPORTING STRUCTURE MUST HOLD OUTRIGGER BEAM LOADS SHOWN WITHOUT FAILURE. LOADS SHOWN WHERE CALCULATED AT FOUR (4) TIMES HOIST RATED CAPACITY.
- *SUPPORTING STRUCTURE MUST HOLD TIEBACK LINES, LIFELINE LOADS SHOWN WITHOUT FAILURE.
- *USE OF SUSPENDED SCAFFOLDING MUST COMPLY WITH OSHA 29 CFR 1926.451(f) AND ANY APPLICABLE LOCAL REGULATIONS.
- *ALL PERSONNEL ON SUSPENDED SCAFFOLDING MUST HAVE AN INDEPENDENT FALL ARREST SYSTEM THAT COMPLIES WITH OSHA 29 CFR 1926.451(g) AND ANY APPLICABLE LOCAL REGULATIONS.
- *SUSPENDED SCAFFOLD RIGGING AND TIEBACKS MUST COMPLY WITH OSHA 29 CFR 1926.451(a) AND 1926.451(d) AND ANY APPLICABLE LOCAL REGULATIONS.
- *LOAD ON SUSPENDED SCAFFOLDING PLATFORM MUST BE UNIFORMLY DISTRIBUTED. PLATFORM MUST REMAIN LEVEL. HOIST MUST BE OPERATED SIMULTANEOUSLY.
- *ALL FIELD CONDITIONS DIFFERING FROM THE DRAWING AND ANY FIELD CHANGES SHALL BE REPORTED TO THE ENGINEER.
- *CONTRACTOR IS RESPONSIBLE TO MAKE SURE ALL EQUIPMENT INSTALLATION MUST CONFORM TO MANUFACTURERS SPECIFICATIONS.
- *ENGINEER AND HS DESIGN STUDIO LLC ARE NOT RESPONSIBLE FOR INSTALLATION AND EQUIPMENT NOT BEING USED PER MANUFACTURERS SPECIFICATIONS.
- *THE CONTRACTOR LISTED ON THE DRAWINGS IS RESPONSIBLE FOR THE DRAWING CONTENTS.

DRAWINGS PREPARED BY:



42 BROADWAY, SUITE 12-282
NEW YORK, NY 10004

SPECIAL RIGGER INFORMATION:
KNS BUILDING RESTORATION INC.
69-44 76TH STREET
MIDDLE VILLAGE, NY 11379
718-366-0075

SPECIAL RIGGER: ANTHONY M. BALLATO
LICENSE NO. 6310

PROJECT ADDRESS:
534 WEST 42ND STREET
NEW YORK, NY 10036



SIGNED AND SEALED

KEY LEGEND

6" MIN. 40' MAX. SUSPENDED
SCAFFOLD PLATFORM



1 OR 2 METER WORK CAGE



C-HOOK



SAFETY LINE
(5/8" DIA. NYLON ROPE WITH
BOWLINE KNOT)

TIEBACK (5/16" DIA. WIRE ROPE)

PARAPET CLAMP



SHEET NO:

SCALE: N.T.S.

SK-01

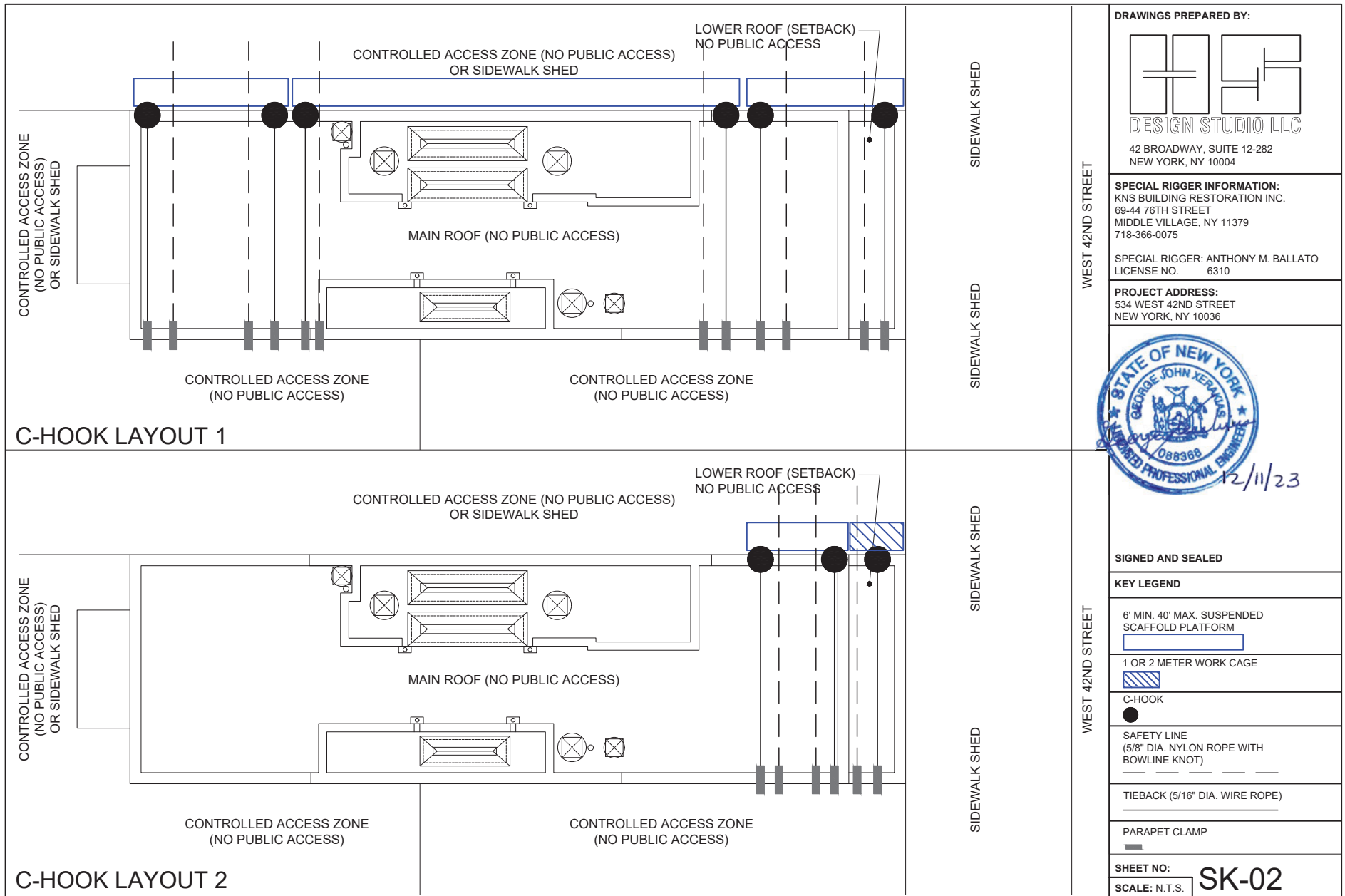

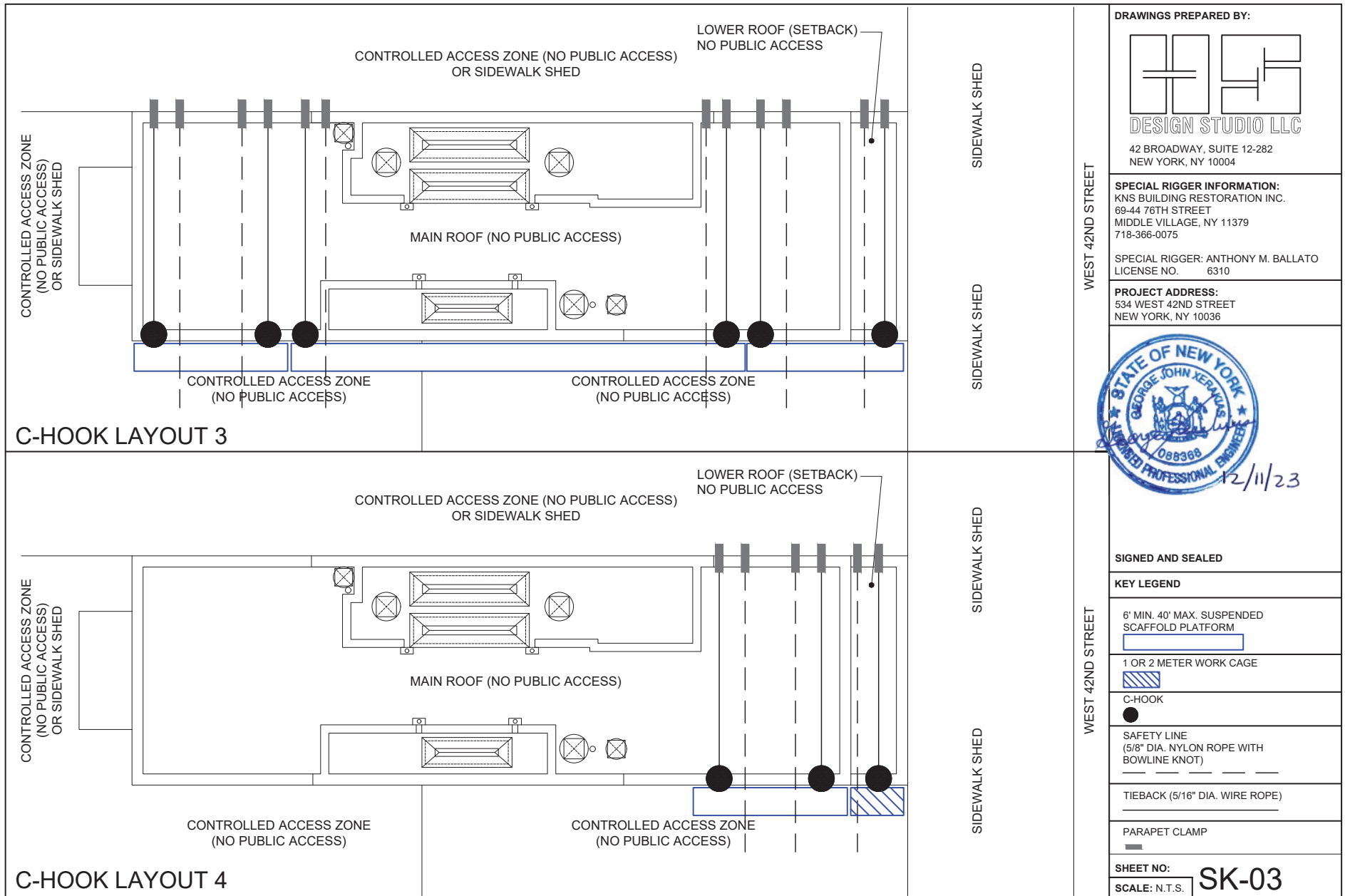

C-HOOK LAYOUT 3

C-HOOK LAYOUT 4

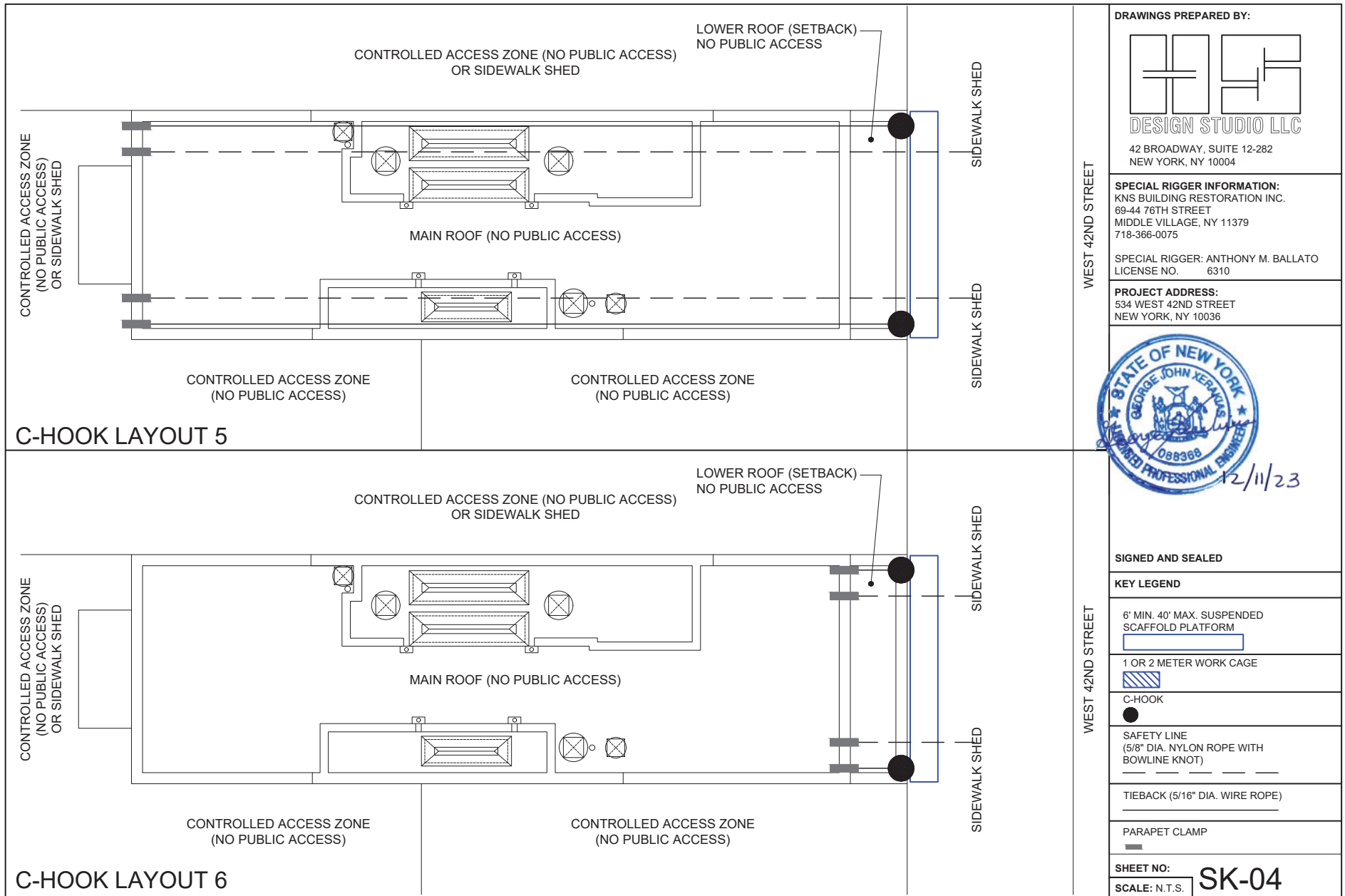

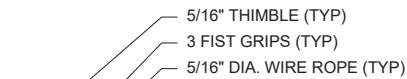

NOTE:
AS PER CODE, TYPICAL DISTANCE BETWEEN FIST GRIPS
SHALL BE AS FOLLOWS: $6 \times (\text{DIAMETER OF THE WIRE ROPE})$
 $= 6 \times (5/16") = 1.86"$

TYP. 5/16" WIRE ROPE ASSEMBLY DETAIL

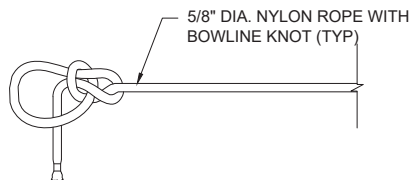

TYP. SAFETY LINE KNOT DETAIL

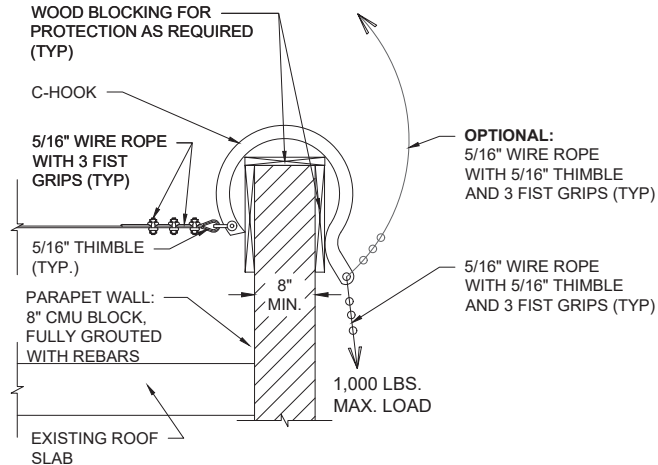

TYP. C-HOOK DETAIL

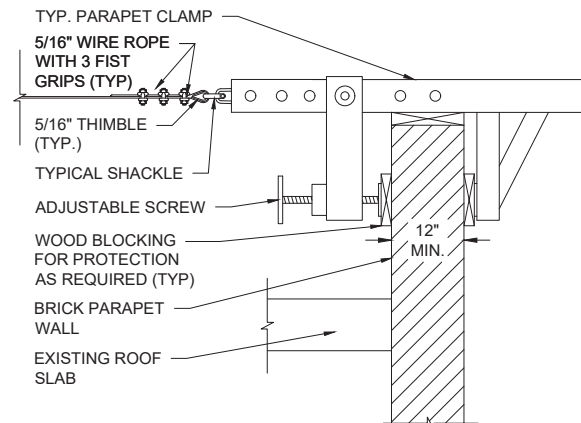

TYP. TIEBACK AT PARAPET CLAMP DETAIL

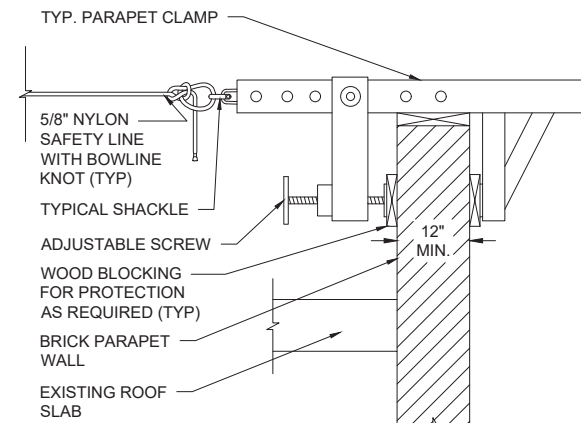

TYP. SAFETY LINE AT PARAPET CLAMP DETAIL

DRAWINGS PREPARED BY:



42 BROADWAY, SUITE 12-282
NEW YORK, NY 10004

SPECIAL RIGGER INFORMATION:
KNS BUILDING RESTORATION INC.
69-44 76TH STREET
MIDDLE VILLAGE, NY 11379
718-366-0075

SPECIAL RIGGER: ANTHONY M. BALLATO
LICENSE NO. 6310

PROJECT ADDRESS:
534 WEST 42ND STREET
NEW YORK, NY 10036



SIGNED AND SEALED

KEY LEGEND

6" MIN. 40' MAX. SUSPENDED
SCAFFOLD PLATFORM

1 OR 2 METER WORK CAGE

C-HOOK

SAFETY LINE
(5/8" DIA. NYLON ROPE WITH
BOWLINE KNOT)

TIEBACK (5/16" DIA. WIRE ROPE)

PARAPET CLAMP

SHEET NO:

SCALE: N.T.S.

SK-06

NOTE:
IF JOBSITE CONDITIONS REQUIRE IT, TIEBACK AND SAFETY LINE TO BULKHEAD SHALL BE USED AS PER THE DETAILS ON THIS PAGE.

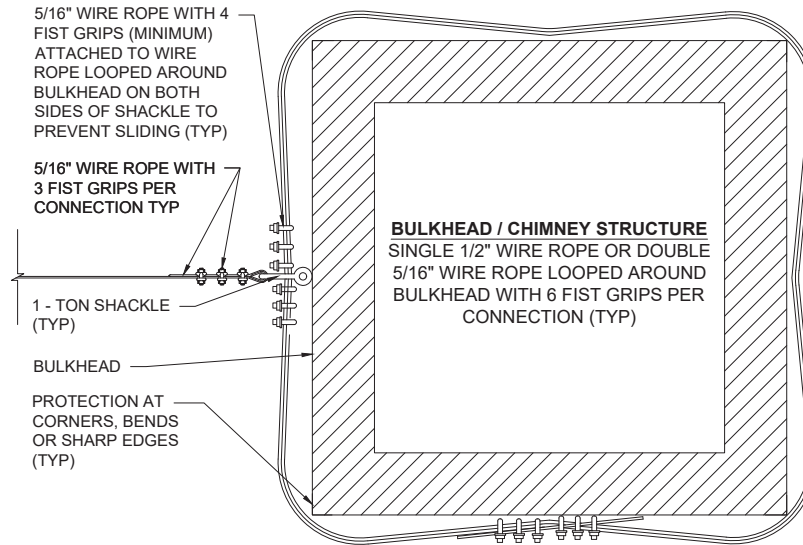

TYP. TIEBACK AT BULKHEAD / CHIMNEY DETAIL

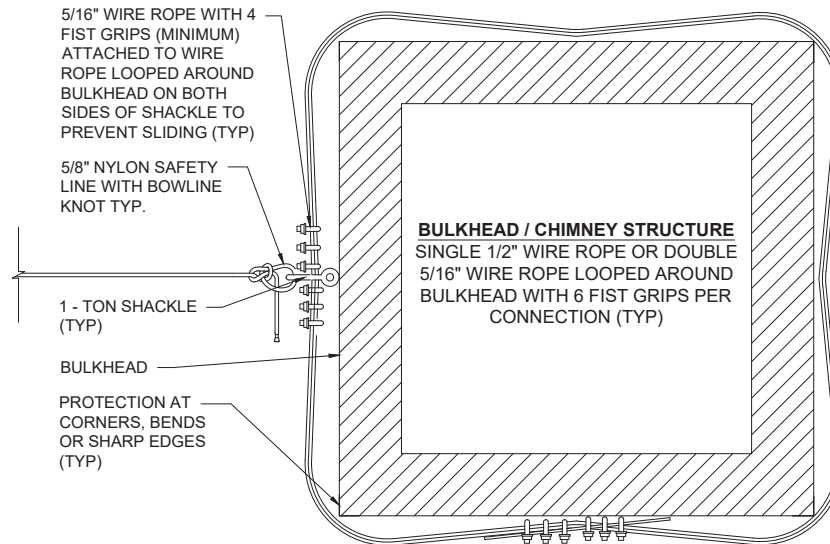

TYP. SAFETY LINE AT BULKHEAD / CHIMNEY DETAIL

DRAWINGS PREPARED BY:



42 BROADWAY, SUITE 12-282
NEW YORK, NY 10004

SPECIAL RIGGER INFORMATION:
KNS BUILDING RESTORATION INC.
69-44 76TH STREET
MIDDLE VILLAGE, NY 11379
718-366-0075

SPECIAL RIGGER: ANTHONY M. BALLATO
LICENSE NO. 6310

PROJECT ADDRESS:
534 WEST 42ND STREET
NEW YORK, NY 10036



SIGNED AND SEALED

KEY LEGEND

6" MIN. 40' MAX. SUSPENDED
SCAFFOLD PLATFORM

1 OR 2 METER WORK CAGE

C-HOOK

SAFETY LINE
(5/8" DIA. NYLON ROPE WITH
BOWLINE KNOT)

TIEBACK (5/16" DIA. WIRE ROPE)

PARAPET CLAMP

SHEET NO:

SCALE: N.T.S.

SK-07