



JAGUAR

Parts Technical Information

Volume J6
Number J1
DATE MARCH 1985

ITEM 1

MODELS SERIES 3 6 CYL MODELS
 SERIES 3 12 CYL MODELS

FICHE RTC9885
 RTC9886

SUBJECT FUEL TANK ELEMENTS

When ordering fuel tanker elements CAC2800 & 1, C27738 & 9,
it will also be necessary to supply the Locking Ring
ARA1501 & Sealing Washer ARA1502.
These two components are not part of the element assy.

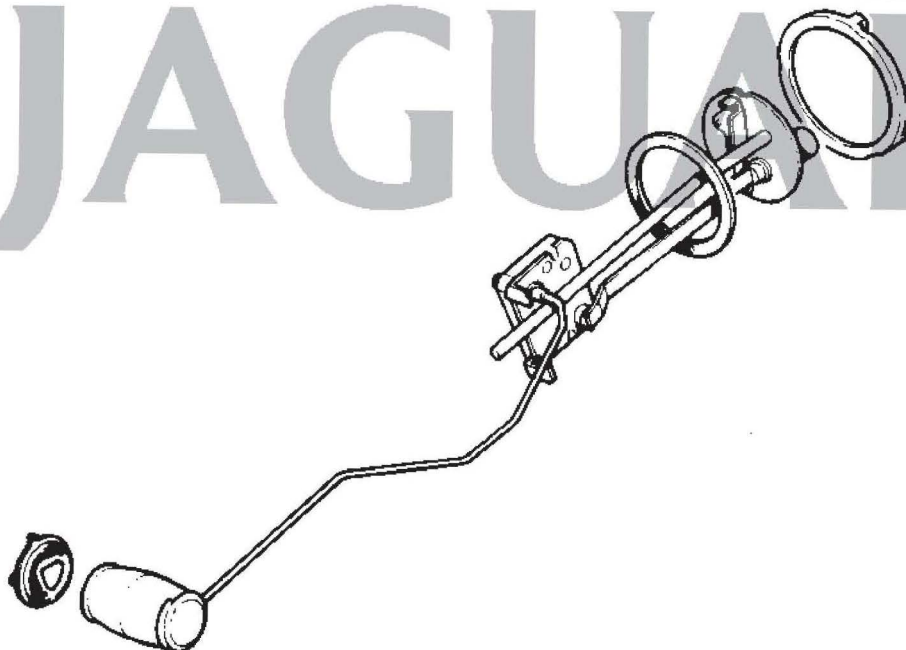

NOTE:- All current parts fiche reflects this policy.

Volume J6
Number J1
DATE MARCH 1985

ITEM 2

MODELS JAGUAR SERIES 3 XJ6
DAIMLER LIMOUSINE

FICHE RTC9885
RTC9887

SUBJECT WATER PUMP

From Engine Nos 8L179779(XJ6 4.2 Litre);8A15831(XJ6 3.4 Litre) and 7M5019(Limousine)a new Water Pump Assembly with larger diameter Bearing and improved Sealing has been introduced. The constituent details are not interchangeable, but JLM206 and EAC6860 Water Pumps can be used as replacements for JLM9699 and fitted.

New Part No	Qty	Description	Existing Part No	Remarks
JLM206	1	Water Pump Assy	JLM9699	XJ6
EAC6860	1	Water Pump Assy	EAC3661	Limousine
EAC6306	1	Pulley	EAC3183	XJ6
EAC6861	1	Pulley	EAC3662	Limousine
EAC6305	1	Bearing	EAC3046	
EAC6447	1	Seal	C28089	
-		Bush	EAC4382	

Volume J6
Number J1
Date March 1985

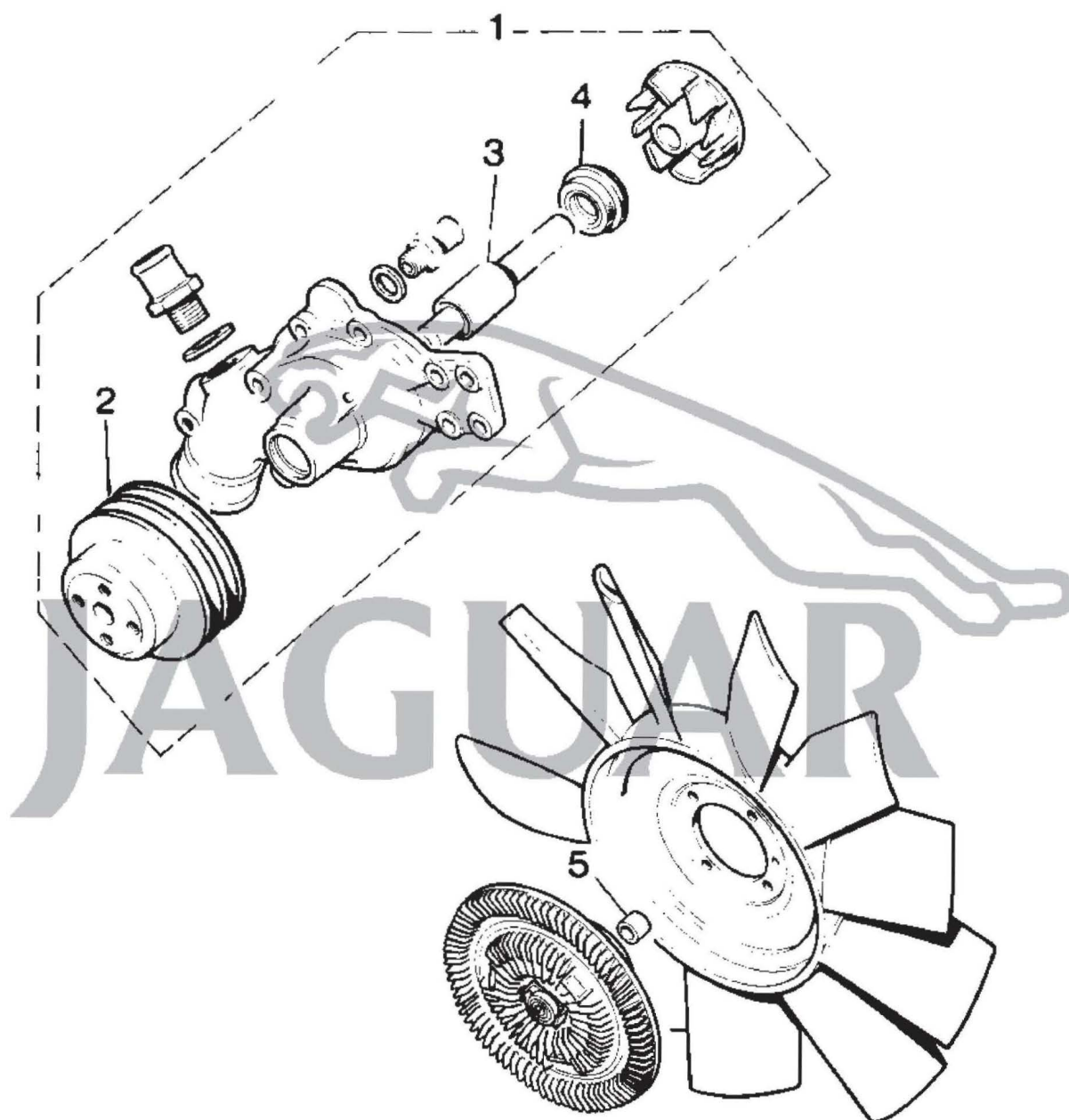

✓ 4-07

Volume J6
Number J1
DATE MARCH 1985

ITEM 3

MODELS JAGUAR XJS 3.6 LITRE

FICHE RTC9889

SUBJECT OIL PUMP CARRIER

From Engine No 9DPBLA100183 a new Oil Pump Carrier has been introduced to enable use of same length of bolt as for Oil Pump Mounting and avoid use of incorrect length of bolt. EAC5674 Carrier can be used as replacement for EAC4474 provided AGU1155 Bolt is used in place of AGU1154.

New Part No	Qty	Description	Existing Part No	Remarks
EAC5674	1	Oil Pump Carrier	EAC4474	
AGU1155	1	Bolt	AGU1154	

ITEM 4

MODELS JAGUAR XJS 3.6 LITRE

FICHE RTC9889

SUBJECT OIL FILLER CAP AND PIPE

From Engine No 9DPAMA101330 a new Oil Filler Cap and 'O' Ring with revised Filler Pipe to suit has been fitted. The individual parts are not interchangeable but the latest details can be used as a 'set'.

New Part No.	Qty	Description	Existing Part No	Remarks
EAC6523	1	Oil Filler Cap	JLM9551	
C42511	1	'O' Ring (Filler Cap)	-	
EAC6434	1	Oil Filler Pipe	EAC5001	

Volume J6
Number J1
DATE MARCH 1985

ITEM 5

MODELS JAGUAR XJS 3.6 LITRE

FICHE RTC9889

SUBJECT CLUTCH SLAVE CYLINDER

From Engine No 9DP8LA101175 a new Clutch Slave Cylinder has been fitted. EAC6801 can be used as a replacement for EAC6120.

New Part No	Qty	Description	Existing Part No.	Remarks
EAC6801	1	Clutch Slave Cylinder	EAC6120	

ITEM 6

MODELS JAGUAR XJS 3.6 LITRE

FICHE RTC9889

SUBJECT CLUTCH COVER

From Engine No 9DPAMA101143 a new Clutch Cover has been fitted. EAC6714 can be used as a replacement for EAC5552.

New Part No	Qty	Description	Existing Part No	Remarks
EAC6714	1	Clutch Cover	EAC5552	

ITEM 7

MODELS JAGUAR XJS 3.6 LITRE

FICHE RTC9889

SUBJECT CLUTCH PLATE

From Engine No 9DPAMA101151 a new Clutch Plate has been fitted. EAC7226 can be used as a replacement for EAC5553.

New Part No	Qty	Description	Existing Part No	Remarks
EAC7226	1	Clutch Plate	EAC5553	

Volume J6
Number J1
DATE MARCH 1985

ITEM 8

MODELS JAGUAR XJS 3.6 LITRE

FICHE RTC9889

SUBJECT WATER HEATED RESISTOR

To prevent whistle under low load conditions a new Water Heated Resistor has been fitted from Engine No 9DPAMA101524. EAC7484 should be used as a replacement for EAC5427.

New Part No	Qty	Description	Existing Part No	Remarks
EAC7484	1	Water Heated Resistor	EAC5427	

ITEM 9

MODELS JAGUAR XJS 3.6 LITRE

FICHE RTC9889

SUBJECT THROTTLE MICRO SWITCH

Micro Switch incorporating longer arm to improve control of Air Pump Switching has recently been introduced.

New Part No	Qty	Description	Existing Part No	Remarks
C33509	1	Throttle Micro Switch	EAC2516	
EAC6851	1	Spacer	-	
AGU1200	2	Setscrew	AGU1197	

Volume J6
Number J1
DATE MARCH 1985

ITEM 10

MODELS JAGUAR XJS 3.6 LITRE

FICHE RTC9889

SUBJECT DIPSTICK

From Engine No 9DPAMA101808 a new Dipstick(with revised oil level marking)to simplify oil level checks has been fitted. EAC7321 Dipstick can be used as a replacement for EAC4775.

New Part No	Qty	Description	Existing Part No	Remarks
EAC7321	1	Dipstick	EAC4775	

ITEM 11

MODELS SERIES 3 6 CYL SALOONS
DAIMLER LIMOUSINE

FICHE RTC9885
RTC9887

SUBJECT THERMO HOUSING GASKETS

Improved Gaskets to prevent coolant loss have now been fitted.

New Part No	Qty	Description	Existing Part No	Remarks
EAC7044	1	Gasket	C28374	3.4/Limo
EAC7045	1	Gasket	C28375	3.4/4.2/Limo
EAC7046	1	Gasket	EAC1282	4.2

The latest type Gaskets can be used as replacement for early type and were fitted from the following:-

Engine No 8L173271 (XJ6 4.2)
Engine No 8A15651 (XJ6 3.4)
Engine No 7M4974 (Limousine)



JAGUAR

Parts Technical Information

Volume J6
Number J6
DATE MARCH 1986

ITEM 19

MODELS All (POLICY ITEM)

SUBJECT BRAKE DISCS

A change in the supply policy on brake discs is shortly to take place. In effect it will mean that individual brake discs will no longer be supplied. This is to ensure that when replacing a defective unit, both discs on that axle are changed to lessen the possibility of brake judder.

New JLM kit numbers will be announced in due course.



JAGUAR

UNIPART CONTRACT SERVICES

Unipart Group Limited Registered Office: Unipart House, Cowley, Oxford OX4 2PG Jaguar Cars Limited 2005
Registered in England No. 576777

Volume J6
Number J6
DATE MARCH 1986

ITEM 20

MODELS DAIMLER LIMOUSINE

FICHE RTC9887

SUBJECT - FUEL FILTER

The "glass bowl" type Fuel Filter has been replaced by XJS type Filter.

New Part No	Qty	Description	Existing Part No	Remarks
EAC3112	1	Fuel Filter	C27588	
CAC6486	1	Mounting Bracket	C29884	

ITEM 21

MODELS XJS (3.6)

FICHE RTC9889

SUBJECT - CYLINDER HEAD GASKET

Commencing at Engine No 9DPAMA 102638 an improved material Cylinder Head Gasket has been introduced and can be used as replacement for EAC2908

New Part No	Qty	Description	Existing Part No	Remarks
EAC7504	1	Cylinder Head Gasket	EAC2908	

Volume J6
Number J6
DATE MARCH 1986

ITEM 22

MODELS XJS (3.6)

FICHE RTC9889

SUBJECT - EXHAUST VALVES AND COTTERS

Commencing at Engine No 9DPAMA 102673 Two Piece Stellite seat Exhaust Valve with revised Cotters and Collars has been introduced.

New			Existing	
Part No	Qty	Description	Part No	Remarks
JLM566	1	Cylinder Head Assy	RTC3027	
EAC7255	12	Exhaust Valve	EAC2910	
EAC7256	12	Cotter (Exhaust Valve)	C27482	
EAC7227	12	Collar (Exhaust Valve)	EAC4709	

Please note that the replaced Cotters and Collars on Exhaust Valve are still required for Inlet Valve.

ITEM 23

MODEL XJS (3.6)

FICHE RTC9889

SUBJECT - EXHAUST MANIFOLD

Commencing at Engine No 9DPAMA 102782 a revised Exhaust Manifold with stiffened cylinder head flange face has been fitted and can be used as replacement for previous.

New			Existing	
Part No	Qty	Description	Part No	Remarks
EAC7264	1	Front Exhaust Manifold	EAC6018	
EAC7261	1	Rear Exhaust Manifold	EAC6019	

Volume J6
Number J6
DATE MARCH 1986

ITEM 24

MODELS - XJS (3.6)

FICHE RTC9889

SUBJECT - CRANK OIL SEAL

From Engine No 9DPAMA 102791 an improved material Crankshaft Oil Seal has been introduced which can be used as replacement for EAC2828

New			Existing	
Part No	Qty	Description	Part No	Remarks
EAC7954	1	Crankshaft Oil Seal	EAC2828	

ITEM 25

MODELS - XJS (3.6)

FICHE RTC9889

SUBJECT - AUXILIARY SHAFT

Commencing at Engine No 9DPAMA 102539 a modified Auxiliary Shaft and redesigned Driving Dog has been introduced. The new details are not interchangeable and when fitting the Steering Pump to engines subsequent to the above Serial No the latest Driving Dog and Coupling must be used.

New			Existing	
Part No	Qty	Description	Part No	Remarks
EAC6741	1	Auxiliary Shaft	EAC6747	
EAC7080	1	Shaft Driving Dog	-	
EAC7643	2	Spirol Pin	-	
FT10825/J	1	Setscrew	-	
EAC7081	1	Pump Driving Dog	EAC3852	
EAC7107	1	Pump Coupling	EAC5090	

Volume J6
Number J6
DATE MARCH 1986

ITEM 26

MODELS - DAIMLER LIMOUSINE

FICHE RTC9887

SUBJECT - MANUAL CHOKE

Commencing at Engine No 7M5099 Automatic Choke Carburettors have been replaced by Manual Choke type.

New Part No	Qty	Description	Existing Part No	Remarks
EAC6829	1	Front Carburettor	EAC6297	
EAC6830	1	Rear Carburettor	EAC6298	
EAC5967	1	Throttle Conn Rod	WZX1037	
EAC5968	1	Choke Conn Rod	-	
EAC8813	1	Throttle Stop Lever	C36480	
EAC5920	2	Carb Adaptor	C45492	
CBC1460/1	1	Choke Cable	-	
BBC7584	1	Bracket (Choke Cable)	-	

ITEM 27

MODEL - SERIES 2 SALOONS

FICHE RTC9883
RTC9884

SUBJECT - DOOR HANDLE GASKETS

The door handle gaskets BD31997 & 9 have been transposed on the illustration. The correct locations are as follows.

BD31997 - Gasket, front of handle
BD31998 - Gasket, rear of handle

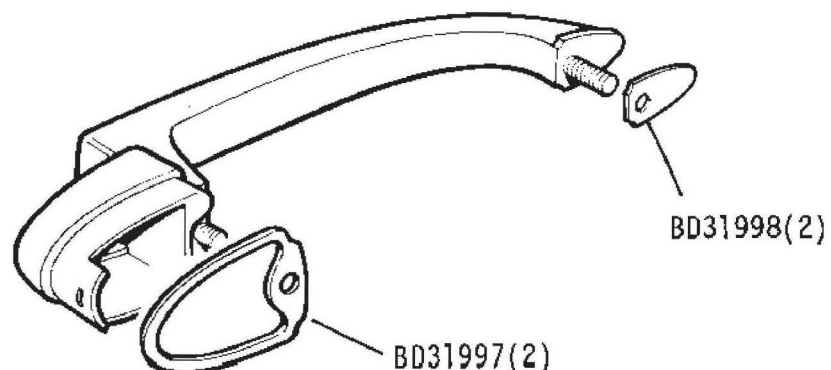



JAGUAR

Parts Technical Information

Volume J6
Number J8
DATE JUNE 1986

ITEM 34

MODELS - XJS/XJ12

FICHE RTC9888/9898

SUBJECT - "Full Flow" Oil Cooling

With reference to Item 33 on Number J7 of Volume J6 please note that the Engine Nos quoted were applicable to Germany only. The relevant Engine Nos for UK Market are 7P56372 (XJ12) and 8S.44317 (XJS)

ITEM 35

MODELS - XJS/XJ12

FICHE RTC9888/9898

SUBJECT - Water Pump

Commencing at 8S.44227 (XJS) and 7P.56379 (XJ12) a new Water Pump with larger diameter bearing has been introduced. The constituent details are not interchangeable but JLM314 Water Pump can be used as a replacement for JLM9697

New			Existing	
Part No	Qty	Description	Part No	Remarks
JLM314	1	Water Pump Assy	JLM9697	
EAC6305	1	Bearing	EAC3036	
EAC6447	1	Seal	C28089	
-		Seat	ERC769	

Volume J6
Number J8
DATE JUNE 1986

ITEM 36

MODELS - XJS

FICHE RTC9888

SUBJECT - Front Water Pipe

From Engine No 8S.440606 an improved Purge Control System with vacuum operated Thermal and Delay valves replacing electrical valve has been fitted. It should be noted that this change affects USA/Canada/Japan/Australia only

New			Existing	
Part No	Qty	Description	Part No	Remarks
EAC9382	1	Front Water Pipe LH	EAC4018	
EAC2630	1	Thermal Valve	-	
EAC9299	1	"T" Piece	-	
EAC9270	1	Delay Valve	-	

ITEM 37

MODELS - XJS/XJ12

FICHE RTC9888/9898

SUBJECT - Fuel Rail Switch

From Engine NO 8S.44060 (XJS) the electrical switch in the Fuel Rail has been replaced with a Vacuum Valve with revised Vac Hoses to Pressure Regulator. This change will also be applicable to XJ12 (No Engine Serial number not yet available)

New			Existing	
Part No	Qty	Description	Part No	Remarks
EAC5086	1	Vacuum Valve	DAC3474	
CAC8050	1	Elbow (Vac Hose)	-	

Volume J6
Number J8
DATE JUNE 1986

ITEM 38

MODELS - XJS (3.6 Litre)

FICHE RTC9889

SUBJECT - Manifold Gaskets

From Engine No 9DPAMA103064 new material Exhaust Manifold Gaskets have been fitted and which may be used for all replacements

New			Existing	
Part No	Qty	Description	Part No	Remarks
EAC8138	1	Gasket - Front Exh Manifold	EAC4279	
EAC8139	1	Gasket - Rear Exh Manifold	EAC4280	

ITEM 39

MODEL - XJS (3.6 Litre)

FICHE RTC9889

SUBJECT - Dipstick Tube

Commencing at Engine No 9DPAMA103628 a revised Dipstick Tube has been introduced and which can be used as replacement for EAC6976

New			Existing	
Part No	Qty	Description	Part No	Remarks
EAC8958	1	Dipstick Tube	EAC6976	

Volume J6
Number J8
DATE JUNE 1986

ITEM 40

MODELS - XJS (3.6 Litre)

FICHE RTC9889

SUBJECT - Tensioner Piston Housing

To improve Chain Control a new secondary Chain Tensioner Piston Housing has been fitted from engine No 9DPAMA103764 and can be used as a replacement for EAC6879

New Part No	Qty	Description	Existing Part No	Remarks
EAC9508	1	Piston Housing	EAC6879	

ITEM 41

MODELS - XJS (3.6 Litre)

FICHE RTC9889

SUBJECT - Cylinder Head and Water Pump

Commencing with Engine No 9DPAMA103840 to improve Heater performance the following details have been fitted

New Part No	Qty	Description	Existing Part No	Remarks
JLM1046/N	1	Stripped Engine	JLM569/N	
JLM1047	1	Cylinder Head Assy	JLM566	
EAC7258	1	Cylinder Head	EAC5230	
EAC7189	1	Adaptor (Heater Feed)	C17421	
C2296/24	1	Washer (Adaptor)	C2296/1	
EAC7243	1	Water Pump Assy	EAC5963	
EAC5442	1	Water Pump Pulley	EAC5481	
EAC7220	1	Water Pump Impellor	EAC4457	
EAC6305	1	Water Pump Bearing	EAC3036	
EAC6447	1	Water Pump Seal	C28089	
EAC7222	1	Heater Return Pipe	EAC6122	
EAC7224	1	Hose (Return Pipe)	EHC5014	



JAGUAR

Parts Technical Information

Volume J6
Number J9
DATE August 1986

ITEM 42

MODELS XJS 3.6 & V12 Models

FICHE RTC9888
RTC9889

SUBJECT Introduction of 1987 Model Year

This list details the changes that took place with the commencement of 1987 Model Year (VIN133102).

Deletion of Service Interval Counter - USA/CDN V12 Models only.

New Part No	Qty	Description	Existing Part No	Remarks
AGU1870	2	Lambda Sensor	AGU1108	
DAC4131	1	Main Cable Harness	DAC4093	
DAC4579	1	Printed Circuit Board	DAC3152	
-	1	Service Interval Counter	DAC4199	

Deletion of Electrically operated Purge/Vent systems.
V-12 Models USA/CDN only

New Part No	Qty	Description	Existing Part No	Remarks
-	1	Thermal Sensor Switch	DAC3474	
-	1	Purge/Vent Valve	DAC2617	
-	1	Purge/Vent Harness	DAC2788	

Introduction of New Style Coachlines.
All V-12 Models

New Part No	Qty	Description	Existing Part No	Remarks
BCC4604	1	Coachline Front Wing Front RH	BAC6568	Gold Leaf
BCC4605	1	Coachline Front Wing Front LH	BAC6569	Gold Leaf
BCC4606	1	Coachline Front Wing Front RH	BAC6570	Gunmetal
BCC4607	1	Coachline Front Wing Front LH	BAC6571	Gunmetal
BCC4608	1	Coachline Front Wing Front RH	BAC6572	Oyster
BCC4609	1	Coachline Front Wing Front LH	BAC6573	Oyster
BCC4610	1	Coachline Front Wing Front RH	-	Dark Red
BCC4611	1	Coachline Front Wing Front LH	-	Dark Red
BCC4612	1	Coachline Front Wing Rear RH	BAC6556	Goldleaf
BCC4613	1	Coachline Front Wing Rear LH	BAC6557	Goldleaf



JAGUAR

Parts Technical Information

Volume J6
Number J10
DATE October 1986

ITEM 45

MODELS - XJ12 (Series 3)

FICHE RTC9898

SUBJECT - Fuel Rail Switch

With reference to Item No 37 of number J8 of Volume J6 please note that the details quoted (for XJS) have now been fitted from Engine No 7P.56939 on XJ12.

ITEM 46

FICHE RTC9897

MODELS - XJ6 (4.2)

SUBJECT - "O" Ring

A new "O" Ring in Viton material has been introduced from Engine No 8L.216061 and can be used as a replacement for C.19869

New Part No	Qty	Description	Existing Part No	Remarks
EAC8840	1	"O" Ring (By-pass Pipe)	C19869	

ITEM 47

FICHE RTC9888/9898

MODELS - XJ12/XJS

SUBJECT - Torque Converter Bolt

Commencing at Engine Nos 7P56152/8S.43515 a new bolt has been introduced to avoid wrong application

New Part No	Qty	Description	Existing Part No	Remarks
EAC5580	6	Bolt	EAC3030	

ITEM 48

FICHE RTC9889

MODELS - XJS (3.6 Litre)

SUBJECT - Fuel Pressure Regulator

From Engine No 9DPAMA103613 a new Pressure Regulator has been fitted

New			Existing	
Part No	Qty	Description	Part No	Remarks
EAC7520	1	Fuel Pressure Regulator	EAC4864	
AGU1329	1	Nut	AGU1287	
WB114001/J	1	Washer	WB116001/J	

ITEM 49

FICHE RC9889

MODELS - XJS (3.6 Litre)

SUBJECT - Breather Hose

Commencing at Engine No 9DPAMA103628 a new Breather Hose has been fitted and which may be used as a replacement for EAC5009

New			Existing	
Part No	Qty	Description	Part No	Remarks
EAC8997	1	Hose (Cam Cover)	EAC5009	

ITEM 50

FICHE RTC9889

MODELS - XJS (3.6 Litre)

SUBJECT - Secondary Chain Tensioner Piston

Commencing with Engine No 9DPAMA103764 a new Tensioner Piston with revised design of ratchet adjuster has been introduced. It should be noted that this Tensioner Piston is applicable to Secondary Chain only and that EAC5317 is still required for Primary Chain.

New			Existing	
Part No	Qty	Description	Part No	Remarks
EAC9607	1	Tensioner Piston	EAC5317	

ITEM 51

FICHE RTC9899

MODELS - XJS (3.6 Litre)

SUBJECT - Engine Dipstick

Commencing at Engine No 9DPAMA104288 at Dipstick with revised markings and finish has been fitted and which can be used as a replacement for EAC7321

New			Existing	
Part No	Qty	Description	Part No	Remarks
EAC9276	1	Dipstick	EAC7321	

ITEM 52

FICHE RTC9898
RTC9888

MODELS Series 3 V12 Saloons
XJS V12 Range

SUBJECT Spark Plugs

The original spark plug EAC8914 specified for all HE V12 engines, has now been replaced by country definitive plugs as detailed below. It is essential that the correct plugs are used at all times.

Country Application

Part Number Required

USA, Australia
Canada Japan

EAC9186(Champion)

All Other Countries

EAC8554(NGK)

The original part EAC8914 is now subject to a Multi Supersession code.



JAGUAR



Parts Technical Information

Volume J6
Number J19
DATE October 1987

ITEM 77

MODELS - XJS (V12)/XJ12

FICHE RTC9898/9900

SUBJECT - Water Pump

To prevent the possibility of Pulley fouling, a new Water Pump has been introduced from VIN.144700 (XJS) and 478348 (XJ12). The previous fixing bolt BH505111/J (7 off) is now 6 off with a countersunk screw SF505101/J added in the relevant location. When using JLM1330 Water Pump (which will include SF505101/J screw) as a replacement for JLM314 the relevant bolt should be discarded and the screw fitted. A revised Thermo Cover (XJS only) and Air Hose have also been introduced from the above VIN.

New			Existing	
Part No	Qty	Description	Part No	Remarks
JLM1330	1	Water Pump Assy	JLM314	
SF505101/J	1	Screw-securing Water Pump	-	
EAC9903	1	Thermostat Cover RH	C42606	XJS only
EAC9866	1	Hose (Extra Air Valve)	EAC7968	

ITEM 78

MODELS - XJ6 (2.9/3.6) XJS (3.6)

FICHE RTC9893/9900

SUBJECT - Oil Seals

The current "Bi-directional" type Oil Seals have now been replaced by "Unidirectional" Seals which can be used as replacement for superseded type. The new seals have been fitted from Engine Nos 9APTMA103777 (XJ6 2.9); 9DPAMA122914 (XJ6 3.6) and 9DPAMA123706 (XJS 3.6).

New			Existing	
Part No	Qty	Description	Part No	Remarks
EAC6156	1	Seal (Auxiliary Shaft)	EAC7263	
EAC5721	1	Seal (Intermediate Shaft)	EAC7263	

Volume J6
Number J19
DATE October 1987

ITEM 79

MODELS - XJ6 (2.9/3.6) XJS (3.6)

FICHE RTC9893/9900

SUBJECT - Sump Baffle

An improved material Sump Baffle is now available and which can be used for all replacements.

New Part No	Qty	Description	Existing Part No	Remarks
EAC7353	1	Baffle Tray (Oil Sump)	EAC5164	

ITEM 80

MODELS - XJ6 (2.9/3.6) XJS (3.6)

FICHE RTC9893/9900

SUBJECT - Setscrews

To improve the sealing and torque retention on certain applications, the Standard Setscrews and loctite have been replaced by Encapsulated Setscrews.

New Part No	Qty	Description	Existing Part No	Remarks
EBC1411	1	Setscrew (Intermediate Shaft)	SH106165/J	XJ6 only
AGU2401/1	1	Setscrew (Intermediate Shaft)	FS106125/J	XJS only
EBC1223	1	Setscrew (Auxiliary Shaft)	FT108255/J	XJ6/XJS

ITEM 81

MODELS - XJ6 (3.6)/XJS (3.6)

FICHE RTC9893/9900

SUBJECT - Camshaft Cover Washers

To improve the oil tightness of Camshaft Covers "Nylatron" washers have now been fitted.

New Part No	Qty	Description	Existing Part No	Remarks
EBC1294	7	Washers (Cam Cover)	FW104/E	

Volume J6
Number J19
DATE October 1987

ITEM 82

MODELS - XJ6 (2.9/3.6)

FICHE RTC9893

SUBJECT - Clutch Slave Cylinder

To reduce pedal load and improve Clutch take-up a new Clutch Slave Cylinder has been introduced and which can be used as a replacement for EAC7651

New Part No	Qty	Description	Existing Part No	Remarks
EAC9044	1	Clutch Slave Cylinder	EAC7651	

ITEM 83

MODELS - XJ6 (3.6)

FICHE RTC9893

SUBJECT - Cylinder Block Heater

A revised engine Block Heater with separate 3 Pin Plug is now fitted to XJ6 (Canada only) vehicles.

New Part No	Qty	Description	Existing Part No	Remarks
EAC9587	1	Heater (Engine Block)	C34403	
EAC9588	1	3 Pin Plug Assy	-	

ITEM 84

MODELS - XJ6 (3.6)/XJS (3.6)

FICHE RTC9893/9900

SUBJECT - Idle Air Valve

To improve the control of Air Flow Metering a revised Idle Air Valve has now been fitted and which can be used as a replacement for EAC6263.

New Part No	Qty	Description	Existing Part No	Remarks
EBC1789	1	Idle Air Valve	EAC6263	

Volume J6
Number J19
DATE October 1987

ITEM 85

MODELS - XJ6 (2.9)

FICHE RTC9893

SUBJECT - Water Temperature Sensor

An improved Temperature Sensor giving more accurate control of ignition has now been introduced and which can be used as a replacement for EAC5713.

New

Part No	Qty	Description	Existing Part No	Remarks
EAC9811	1	Water Temperature Sensor	EAC5713	

ITEM 86

MODELS - XJ6 (3.6)/XJS (3.6)

FICHE RTC9893/9900

SUBJECT - Pistons

Commencing at VIN521255 (XJ6 3.6) and VIN144344 (XJS 3.6) High Comp Pistons have been replaced by new lightweight Pistons. It should be noted that from the above VIN the new High Comp Pistons will also replace Std Comp ratio Pistons on XJ6 3.6 vehicles for USA and Canada.

New

Part No	Qty	Description	Existing Part No	Remarks
EBC1288/S	6	Piston Assy	EAC8744/S	UK
EBC1288/20	6	Piston Assy	EAC8744/20	UK
EBC1288/S	6	Piston Assy	EAC8746/S	USA/CDN
EBC1288/20	6	Piston Assy	EAC8744/20	USA/CDN

ITEM 87

MODELS - Daimler Limousine

FICHE RTC9887

SUBJECT - Fan Belt

Note that due to specification error that the Part number for the Fan Belt on above model should read C28956/2 and not EAC1348 as currently published.

New

Part No	Qty	Description	Existing Part No	Remarks
C28956/2	1	Fan Belt	EAC1348	



JAGUAR

Parts Technical Information

Volume J6
Number J21
DATE DECEMBER 1987

ITEM 90

MODELS XJS RANGE

SUBJECT - REAR LENS ASSEMBLIES

Supplies of the original type rear lens assemblies are no longer available. To ensure interchangeability, the lens will now be supplied minus the trim infill which can be ordered as a kit (contains RH & LH infills).

New Part No	Qty	Description	Existing Part No	Remarks
JLM1551	1	Lens Unit - RH	RTC1206 AEU2495 AEU2556	Not USA/CDN " "
JLM1552	1	Lens Unit - LH	RTC1207 AEU2494 AEU2555	Not USA/CDN " "
JLM1553	1	Lens Unit - RH	RTC1204 AEU1093 AEU2554	USA/CDN " "
JLM1554	1	Lens Unit - LH	RTC1205 AEU1095 AEU2553	USA/CDN " "
JLM1548	1	Trim Infill Kit	-	All Markets
JLM1549	1	Trim Infill RH	-	"
JLM1550	1	Trim Infill LH	-	"

Volume J6
Number J21
DATE DECEMBER 1987

ITEM 90 continued

MODELS XJS RANGE

SUBJECT - REAR LENS ASSEMBLIES

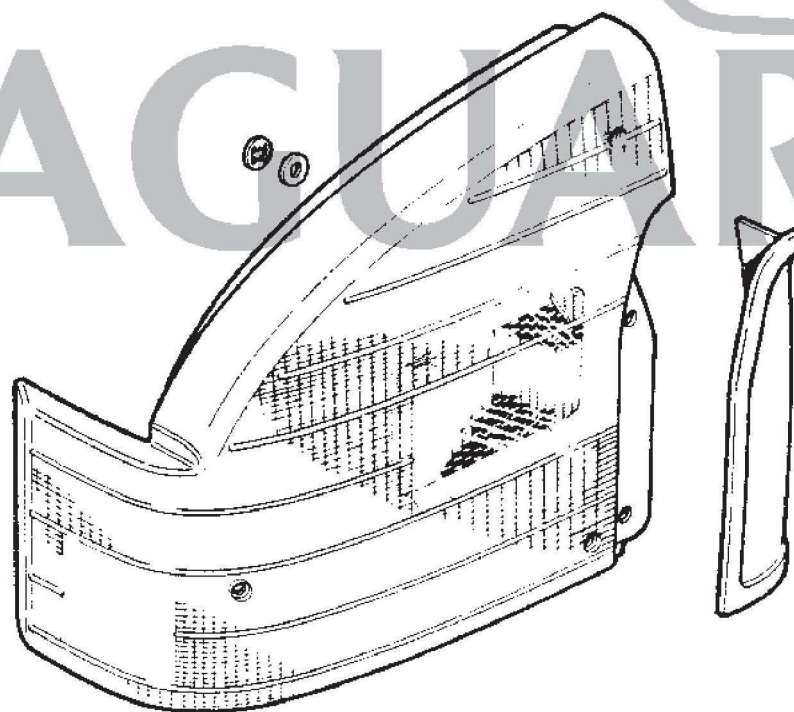

Fig 1 - Rear Lens and Trim Infill

Volume J6
Number J21
DATE DECEMBER 1987

ITEM 91

MODELS XJ6(2.9/3.6)/XJS (3.6)

FICHE RTC9893/9900

SUBJECT - CRANKSHAFTS

Commencing at Engine Numbers 104356 (2.9 Litre) and 128811 (3.6 Litre) a redesigned Crankshaft has been fitted. It should be noted that this new Crankshaft deleted the need for Balance Bolts on Driveplate and Balance Weights on the Crank Damper.

New			Existing	
Part No	Qty	Description	Part No	Remarks
JLM1564/N	1	Engine Assy (High Comp)	JLM1338/N	XJS (3.6)
JLM1565/N	1	Engine Assy (Std Comp)	JLM1339/N	XJS (3.6)
JLM1566/N	1	Engine Assy (High Comp)	JLM1423/N	XJ6 (3.6)
JLM1567/N	1	Engine Assy (Std Comp)	JLM1310/N	XJ6 (3.6)
JLM1568/N	1	Engine Assy (High Comp)	JLM1307/N	XJ6 (2.9)
JLM1569/N	1	Engine Assy (Std Comp)	JLM1308/N	XJ6 (2.9)
EBC1147	1	Crankshaft	EAC7730	3.6 Litre
EBC1148	1	Crankshaft	EAC8274	2.9 Litre
-		Balance Bolt	EAC9798	2.9 Litre
-		Balance Bolt	EAC9799	3.6 Litre
-		Balance Weights	EBC1310/A-I	XJ6 Only
-		Balance Weights	EBC9911/A-I	XJ6 Only
-		Balance Weights	EAC9921/A-I	XJS 3.6 Only
-		Setscrew	EBC1433	XJ6 Only

Volume J6
Number J21
DATE DECEMBER 1987

ITEM 92

MODELS XJ6 (2.9 Litre)

FICHE RTC9893

SUBJECT - SOLENOID VALVE BRACKET

Solenoid Valve EAC7904 is now mounted to Starter Solenoid Link Lead connector Clip. This deletes the need to use Valve Mounting Bracket which had now been deleted and a revised Vac Hose end Connector fitted.

New Part No	Qty	Description	Existing Part No	Remarks
	1	Mounting Bracket	EAC6926	
	1	Screw - Securing Bracket	FS108161/J	
C33835	1	Connector	-	
EAC8021/18	1	Vac Hose	-	

ITEM 93

MODELS XJS (3.6)/XJ6 (2.9/3.6)

FICHE RTC9893/9900

SUBJECT - FLYWHEEL

A revised Flywheel has now been fitted and can be used as a replacement for EAC8192.

New Part No	Qty	Description	Existing Part No	Remarks
EBC1832	1	Flywheel Assy	EAC8192	

Volume J6
Number J21
DATE DECEMBER 1987

ITEM 94

MODELS XJS (3.6 LITRE)

FICHE RTC9889/9900

SUBJECT - STRIPPED ENGINE ASSY

Commencing at Engine Number 9DPAMA128811 a revised Engine with redesigned Crankshaft eliminating the need for Balance Weights on Crank Damper and Driveplate has been introduced.

The Engine (Part Number JLM1564/N) can be used as a replacement for JLM1338/N (1987½ Micro Fuel Engine) and for Pre Micro Fuel Engines as follows:-

- A/ PRE MICRO FUEL ENGINES AFTER 9DPAMA103840
Refit original Crank Damper, Timing Disc and Timing Indicator from old Engine. Fit EAC6889 Stud Bolt in relevant location on Cylinder Head Rear Cover. Discard Oil Filler Tube Housing from old Engine and replace with EAC7443 Oil Filler Tube Housing; EAC7441 Oil Drain Pipe; EAC4927 Nut; EAC4929 Olive; EAC7407 Hose; and EAC3215/1 Hose Clips (2 off) to suit revised Oil Sump.
- B/ PRE MICRO FUEL ENGINES FROM 9DPAMA102539 UP TO 103839
Details as A above plus fit CAC9801 Heater Feed Hose to suit longer diameter Adaptor on Cylinder Head.
- C/ PRE MICRO FUEL ENGINES UP TO 9DPAMA102538
Details as A and B above plus discard EAC3852 Driving Dog and EAC5090 Coupling and replace with EAC7081 Driving Dog and EAC7107 Coupling to secure Steering Pump to revised Auxiliary Shaft.

Volume J6
Number J21
DATE DECEMBER 1987

ITEM 95

MODELS XJ6 2.9 & 3.6 Litre

FICHE RTC9893

SUBJECT - HEADLAMP UNITS

In order to clarify the requirements for inner and outer headlamp units the following part numbers have been redefined.

JLM216 - Outer) CDN/USA
JLM215 - Inner) CDN/USA

JLM845 - Outer) Japan
JLM844 - Inner) Japan

JLM174 - Outer LHD not CDN/J/USA
JLM175 - Outer RHD
JLM173 - Inner RHD & LHD Not CDN/J/USA

ITEM 96

MODELS Series 3 6 Cylinder Saloons
Series 3 12 Cylinder Saloons

FICHE RTC9897
RTC9898

SUBJECT - PARTS CATALOGUES

Two new parts catalogues are now available for the Series 3 6 & 12 Cylinder Saloons, August 1985 onwards. Orders may be submitted through the normal procedures.

New

Part Number	Description
RTC9897CA	Series 3 6 Cylinder Saloons August 1985 onwards.
RTC9898CA	Series 3 12 Cylinder Saloons August 1985 onwards.

Volume J6
Number J21
DATE DECEMBER 1987

ITEM 97

MODELS XJ6 2.9 & 3.6 Litre

FICHE RTC9893

SUBJECT - WORKSHOP CONSUMABLES

Four new workshop consumables are now available. These products are recommended by Jaguar for the applicators detailed below:-

Part No	Description	Application
JLM1494	Electrolube 20ml Syringe) Bulb Failure
*JLM1253	Electrolube 200ml Spray) Modules Connectors
JLM1247	Loctite 574 50ml Sealant	Rear Cover, Cylinder Head
JLM1227	Loctite 510 50ml Sealant	Oil Pump rebuild

* JLM1253 is not recommended for use in North America

ITEM 98

MODEL XJ6 (3.6)/XJS (3.6)

FICHE RTC9893/9900

SUBJECT - CAMSHAFTS

Improved Camshafts have been introduced and which can be used as replacements for EAC8523/EAC8525.

New Part No	Qty	Description	Existing Part No	Remarks
EAC9535	1	Inlet Camshaft	EAC8523	
EAC9534	1	Exhaust Camshaft	EAC8525	

Volume J6
Number J21
DATE DECEMBER 1987

ITEM 99

MODELS Daimler Limousine

FICHE RTC9887

SUBJECT - DRIVEPLATE

A new Driveplate incorporating Countersunk Rivets replacing Dome Head Rivets has now been introduced and can be used as a replacement for EAC2996.

New Part No	Qty	Description	Existing Part No	Remarks
EAC6391	1	Driveplate Assy	EAC2996	

ITEM 100

MODELS XJ6 (2.9/3.6)/XJS (3.6)

FICHE RTC9893/9900

SUBJECT - THROTTLE BODY

New Throttle Bodies have now been introduced and which can be used as replacements for EAC8001/8002. This new Throttle Body has Stub Pi Holes undrilled to eliminate the use of plugs to blank off used holes

New Part No	Qty	Description	Existing Part No	Remarks
EBC2108	1	Throttle Body	EAC8002	Emiss B only
EBC2107	1	Throttle Body	EAC8001	All Other Market

ITEM 101

MODELS XJ12 - XJS

FICHE RTC9898/9900

SUBJECT - GM 400 GEARBOX

When using Gearbox EAC7702/N in lieu of Gearbox EAC4046/N the oil cooler connector AEU1077 (2 off) must be retained and fitted in lieu of JLM535 (2 off)

New Part No	Qty	Description	Existing Part No	Remarks
EAC7702		Gearbox Assy	EAC4046/N	

Volume J7
Number J1
DATE February 1988

ITEM 3

MODELS - XJ6 (2.9/3.6)/XJS(3.6)

FICHE RTC9893/9900

SUBJECT - Throttle Body

Commencing at Engine No 104975 (2.9 Litre) and 139500 (3.6 Litre) a Dual Canister Purge System has been introduced. On Engines this involves an additional outlet stub on the Throttle Body, a revised Supplementary Air Adaptor and an additional Thermal Valve fitted in Thermo Housing.

New			Existing	
Part No	Qty	Description	Part No	Remarks
EBC2344	1	Throttle Body	EBC2107)
EAC2630	1	Thermal Valve	-) Emission
EBC2351	1	Supplementary Air Adaptor	EAC7759) A/C/D/E
EBC2381	1	Supplementary Air Adaptor	EAC5838	Emiss B/F

ITEM 4

MODEL - XJ6 (3.6)/XJS (3.6)

FICHE RTC9893/9900

SUBJECT - Inlet Manifold

Revised Manifolds deleting the need for a Deceleration Valve have now been introduced. When using the new Manifolds as replacements for EAC7748/EAC8989 the Decel Valve must be discarded.

New			Existing	
Part No	Qty	Description	Part No	Remarks
EBC2054	1	Inlet Manifold	EAC7748	XJ6 (3.6)
EBC2057	1	Inlet Manifold	EAC8989	XJS (3.6)
-	1	Deceleration Valve	EAC9440	



Parts Technical Information

Volume J8
Number J1
DATE March 1989

ITEM 1

MODELS Series II 6 Cylinder Models

FICHE RTC9883FE

GROUP Engine

SUBJECT Oil Filter Element

REASON FOR CHANGE The replacement oil filter element, JLM9546 has been found to be 1/8" under dimension. To compensate for this shortfall a plain washer, WA600071/J must be fitted between the pressure spring and the oil filter canister. (See illustration below.)

Part No.	Qty	Description
JLM9546	1	Oil Filter Element
WA600071/J	1	Plain Washer

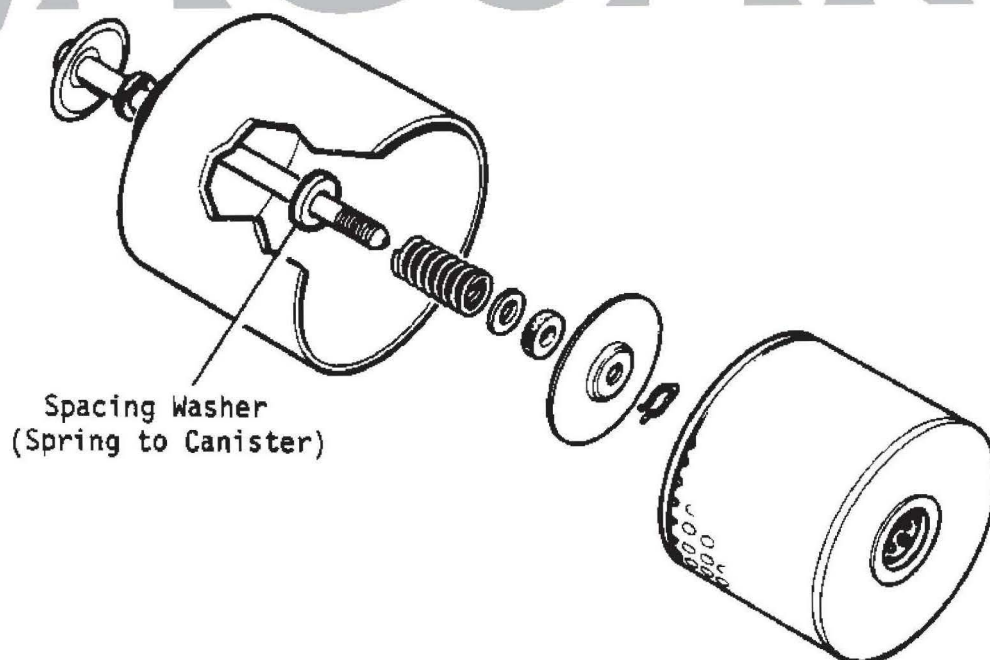

Volume J8
Number J1
DATE March 1989

ITEM 2

MODELS XJS 3.6 Litre

FICHE RTC9900

GROUP Electrical, Washers, Wipers and Instruments

SUBJECT Cradle Bracket

REASON FOR CHANGE From VIN156438 a new Cradle Bracket
was fitted.

New Part No.	Qty	Description	Existing Part No.	Remarks
DBC5026	1	Cradle Bracket, PI Harness	DBC2539	

ITEM 3

MODELS 2.9 and 3.6 Litre Saloons

FICHE RTC9893

GROUP Electrical, Washers, Wipers and Instruments

SUBJECT Bulb Failure Module

REASON FOR CHANGE From VIN571392, revised Bulb Failure Modules
were fitted to Norway and Sweden vehicles.

New Part No.	Qty	Description	Existing Part No.	Remarks
DBC3739	2	Bulb Failure Module, Front	DCB3267	Quads
DBC3740	2	Bulb Failure Module, Front	DBC3268	Styled



Parts Technical Information

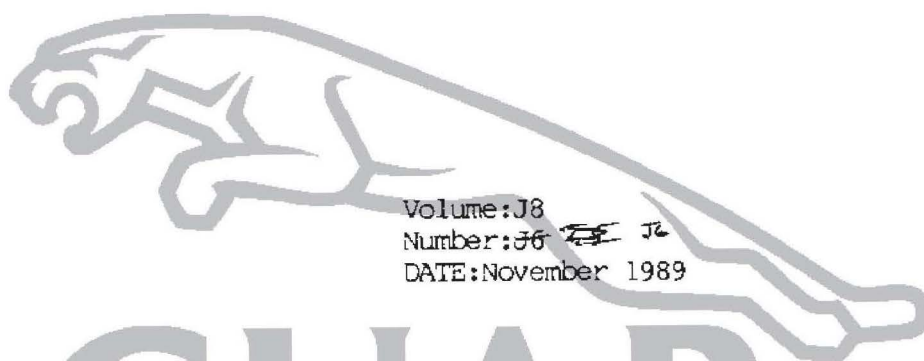

Volume: J8
Number: ~~36~~ ^{J6}
DATE: November 1989

ITEM: 48

MODELS: XJS

FICHE: RTC9900

GROUP: Bodyshell & Fitting

SUBJECT: Gasket - Bumper Mounting

REASON FOR CHANGE: Parts Technical Information VJ8 No. J4 Item 43 lists the plain washer as BEC 1990. This is incorrect. The correct part number should be BEC 1900.

New Part No.	QTY	Description	Existing Part No
BEC1900	6	Plain Washer	WC108051J

Volume:J8
Number:J6
DATE:November 1989

ITEM: 49

MODELS: Series 3 5.3 litre Saloons
XJS Range
GROUP: Bodysell & Fittings

FICHE: RTC9898
RTC9900

SUBJECT: Door Mirrors

REASON FOR CHANGE: To comply with EEC Directive 85/205, France
will now use Convex door mirror glass in lieu
of flat.

New Part No.	QTY	Description	Existing Part No
Series 3 5.3 litre			
BBC4958	1	Mirror - RH	BBC4954
BBC4959	1	Mirror - LH	BBC4955
XJS			
BDC8166	1	Mirror - RH	BDC8164
BDC8167	1	Mirror - LH	BDC8165

Volume:J8
Number:J6
DATE:November 1989

ITEM: 50

MODELS: XJ6 Saloons

FICHE: RTC9893

GROUP: Facia, Trim, Seats & Fixings

SUBJECT: Locking Button

REASON FOR CHANGE: To incorporate various changes in the
Top Crash Rolls - doors & locking button
surround.

New Part No.	QTY	Description	Existing Part No
CRASH ROLL-TOP-DOOR			
BDC7286	1	Front - RH	BDC8044
BDC7287	1	Front - LH	BDC8045
BDC7288	1	Rear - RH	BDC8408
BDC7289	1	Rear - LH	BDC8409
BCC9790	1	Locking Button surround	BBC9033

Volume:J8
Number:J6
DATE:November 1989

ITEM: 51

MODELS: XJ6 Saloons

FICHE: RTC9893

GROUP: Fuel, Exhaust & Emission Systems

SUBJECT: Fuel Hose

REASON FOR CHANGE: From 14-08-89, new fuel hoses with new
end fittings were introduced.

New Part No.	QTY	Description	Existing Part No	Remarks
CBC8183	1	Fuel Hose Socket & Hose Assy	CBC1474	
CBC8185	1	Fuel Hose Assy - U/Floor Pipe To Tank	CBC2573	

Volume:J8
Number:J6
DATE:November 1989

ITEM: 52

MODELS: XJ6 Saloons (1990 MY)

FICHE: RTC9893

GROUP: Electrical, Washers, Wipers & Instruments

SUBJECT: Harnesses

REASON FOR CHANGE: To incorporate component updates, from
(v) 594576 the undermentioned harness
and link lead were introduced.

New Part No.	QTY	Description	Existing Part No	Remarks
DBC5913	1	Harness, Auto Trans	DBC5368	
DBC5914	1	Harness, Electronic Gearbox	DBC5369	
DBC5930	1	Link Lead - Powered Seat	DBC5752	

Volume:J8
Number:J6
DATE:November 1989

ITEM: 53

MODELS: Series 3 5.3 litre Saloons

FICHE: RTC9898

GROUP: Facia, Trim, Seats and Frames

SUBJECT: Parcel Shelf

REASON FOR CHANGE: From (v) 482561 new rear parcel shelf assys
were incorporated to cator for the "Child Tether"
anchorage system.

New Part No.	QTY	Description	Existing Part No	Remarks
BEC6385	1	Parcel Shelf Assy - Trimmed XJ12/Sovereign	BCC6442	
BEC6382	1	Parcel Shelf Assy - Trimmed Daimler/Vanden Plas	BCC6445	

Volume:J8
Number:J6
DATE:November 1989

ITEM: 54

MODELS: Series 3 5.3 litre Saloons
XJS 5.3 litre Range
GROUP: Engine

FICHE: RTC9898
RTC9900

SUBJECT: Joint - Timing Covers

REASON FOR CHANGE: From (E) 7P62981 - Saloons & 8S71536 - XJS
new thickness timing cover joints were
introduced.

New Part No.	QTY	Description	Existing Part No	Remarks
EBC3280	1	Joint - LH	C29337	
EBC3281	1	Joint - RH	C29338	
EBC3282	1	Joint - Top	C29339	

Volume:J8
Number:J6
DATE:November 1989

ITEM: 82

MODELS: XJS (3.6 litre)

FICHE: RTC9900

GROUP: Engine

SUBJECT: C/S Sensor Bracket

REASON FOR CHANGE: To enable XJS 3.6 litre UK Emission "B" Engine to run on 95 Octane Unleaded Fuel a revised Crankshaft Sensor Bracket has been fitted from Engine No. 9DPAMA 192588

New Part No.	QTY	Description	Existing Part No	Remarks
EBC3383	1	Bracket - C/S Sensor	EBC1253	
SF108251/J	1	Setscrew - Securing Bracket	FB108111/J	

Volume:J8
Number:J6
DATE:November 1989

ITEM: 83

MODELS: XJ12/XJS (V12)

FICHE: RTC9898
RTC9900

GROUP: Engine

SUBJECT: Oil Filler Cap

REASON FOR CHANGE: Standardisation of Oil Filler Cap - the XJ6
(2.9/3.6) type filler cap EAC6523 has been
fitted to above models from Engine Nos 7P62873
(XJ12) and 8S71033 (XJS-V12)

New Part No.	QTY	Description	Existing Part No	Remarks
EAC6523	1	Oil Filler Cap	C34757	

JAGUAR

Volume:J8
Number:J6
DATE:November 1989

ITEM: 84

MODELS: XJ6 (2.9/3.6/4.0) - XJS (3.6)

FICHE: RTC9893
RTC9900

GROUP: B

SUBJECT: Cylinder Head Gasket

REASON FOR CHANGE: Non Asbestos Cylinder Head Gaskets have been fitted to above models from Engine Nos 112000(2.9 litre), 192654 (3.6 litre) and 105739 (4.0 litre)

New Part No.	QTY	Description	Existing Part No	Remarks
EBC1550	1	Cylinder Head Gasket	EAC7503	2.9 litre
JLM2100	1	Cylinder Head Gasket Set	JLM836	
EBC1551	1	Cylinder Head Gasket	EAC7504	3.6/4.0 litre
JLM2101	1	Cylinder Head Gasket Set	JLM113	

Parts Technical Information

Parts Technical Services
Telephone No. (0) 203 307767
Facsimile No. (0) 203 305625

DATE: February 1993

P.T.I.: 164

REASON FOR CHANGE:

Please note the following oil filter **EBC 10303** may be used as an alternative to **C 42797**.



PARTS OPERATIONS



Parts Technical Information

Parts Technical Services
Facsimile No. (0)1203 404036

DATE: November 1994

P.T.I.: 176

FICHE: Various

SUBJECT: 6 Cyl Engine Fuel Injectors

For ease of identification during engine assembly at Jaguar, Fuel Injectors are identified with a different coloured band.

Fuel Injectors supplied via Parts Operations do not use this system and all have the same coloured band.

Once removed from the packaging these Injectors can only be identified using the supplier reference stamped on the side of the part. See below for details:

Part No.	Production Ident. Colour	Service Ident. Colour	Supplier Prod. Ref.	Supplier Service Ref.
DBC 10423	White	Green	D 3156KA	D 3156AA
DBC 11041	Red	Green	D 3165KA	D 3165AA
EBC 4430	Green	Green	D 3155KA	D 3155AA

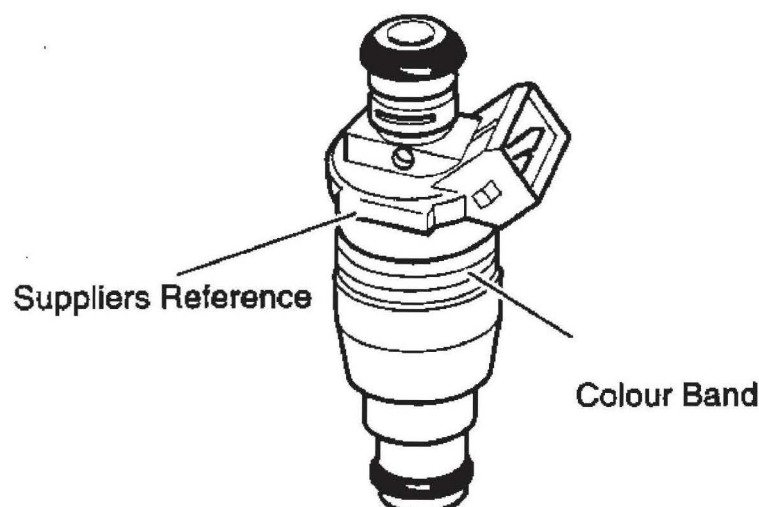

VS6043

PARTS OPERATIONS



Parts Technical Information

Parts Technical Services

Facsimile No. (0)1203 404036

DATE: December 1994

P.T.I. : 178

FICHE: RTC 9910 FH
RTC 9918 FF
RTC 9922 FC

MODELS: XJS Range
Jaguar Saloon Range
The New XJ Series

SUBJECT: JLM 11649 - Cylinder Head Gasket Set

Gasket Sets bought prior to 12/12/94 may incorrectly contain EBC 3531 - Seal-Valve Stem.

These are not suitable for 7 mm diameter Valve Stems and should be substituted with EBC 3956 (Quantity 24).

VS6043