

# ***STINGER* 2000**

High Performance Oilless Commercial  
Refrigerant Recovery Unit

## **User Manual**

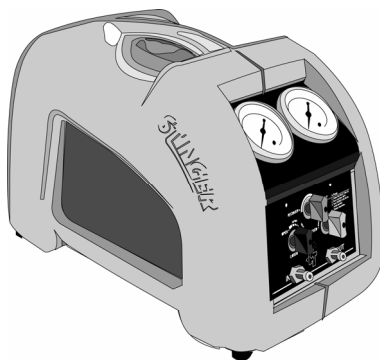

# Introduction

---

Congratulations on your purchase of the STINGER high performance oilless recovery unit. Bacharach has worked hard to make the STINGER the highest performing, most portable, and easiest to use recovery unit on the market. We are committed to your complete satisfaction!

**CAUTION:** These instructions are for personnel trained and experienced in the handling of refrigerants. Unqualified individuals should not attempt to operate this equipment. Failure to follow proper operating procedures may cause personal injury.

**WARNING:** Inhalation of high concentrations of refrigerant vapors is harmful and may cause heart irregularities, unconsciousness, or death. Deliberate inhalation of refrigerants is extremely dangerous and death can occur without warning. Vapors reduce oxygen available for breathing and are heavier than air. Decomposition products are hazardous. Liquid contact may cause frostbite. All refrigerant containers, equipment, and hoses are under pressure.



**CAUTION!** Before operating this unit, please read this manual in its entirety. It is important that you have a thorough understanding of the procedures outlined in this manual. Failure to follow these procedures could void all manufacturer warranties.



**WARNING!** This unit is capable of over-pressurizing a DOT recovery cylinder. Ensure that you are using the proper DOT recovery cylinder for the refrigerant that you are recovering. NOTE: R-410 is capable of pressures exceeding 600 psi. Typical DOT recovery cylinders are rated at 350 psi with a pressure relief set at 550 psi. These cylinders should not be used with R-410A. Only cylinders rated at 400 psi with the relief valve setting at 600 psi should be used to for R-410A. Failure to use the proper cylinder can be extremely dangerous!



**BEFORE** handling refrigerants, read the material safety data sheet from the refrigerant manufacturer

# STINGER Specifications

STINGER 2000				
Compatible Refrigerants	R-12, R-22, R-114, R-134a, R-401A, R-401B, R-401C, R-402A, R-402B, R-404A, R-406A, R-407A, R-407B, R-407C, R-407D, R-408A, R-409A, R-410A, R-411A, R-411B, R-412A, R-500, R-502, R-507, R-509			
Power	• 110/120 VAC, 1 Phase, 50/60 Hz, 8 Amps • 220 VAC, 1 Phase, 50/60 Hz, 4 Amps			} See label on back of unit
Compressor	¾ HP High Performance Oilless			
Cooling	Two Cooling Fans			
Protection	High pressure cutoff at 550 psi. Compressor is protected by circuit breakers and internal thermal sensor. Optional 80% tank full automatic shutoff.			
Pressure Ratings	Low Side design pressure 450 PSI High Side design pressure 550 PSI			
Temperature	Operating Range 32 to 104 °F (10 to 40 °C)			
Case	Blow-Molded, High Impact Polyethylene			
Size / Weight	Length 17"			
	Width 9.5"			
	Height 11"			
	Weight 24 Lbs.			
Certification	Complies with UL1963; CSA 22.2 No. 120-M91			
Refrigerant Recovery Rates				
Certified per ARI 740-98				
Refrigerant	Liquid Rate	Liquid Push-Pull Rate	Vapor Rate	Vacuum Level (inches Hg)
R-22	3.88 lb/min	14.00 lb/min	0.33 lb/min	>15

# Table of Contents

---

Introduction.....	2
STINGER Specifications .....	3
Table of Contents .....	4
General Safety .....	5
Operational Safety.....	6
Description of Features .....	7
Vapor/Liquid Recovery Operations.....	9
Standard Recovery Hose Connections .....	10
Liquid Push-Pull Recovery Operations.....	11
Liquid-Pull Recovery / Charging Method .....	13
R-410A Recovery – Special Notes .....	14
Purging the STINGER.....	15
DOT Recovery Cylinder Safety .....	16
Recovery Tips .....	17
Troubleshooting.....	18
Schematic Diagrams .....	19
STINGER Parts List .....	20
STINGER Exploded View.....	21
Compressor Parts List.....	22
Compressor Exploded View .....	23
Warranty / Repair Procedures.....	24

# General Safety

---

## **Know your equipment**

Read and understand the User Manual and labels affixed to the unit. Learn the application and limitations as well as the specific potential hazards of your equipment.

## **Ground all equipment**

This unit is equipped with a three-pronged grounded power cord.

## **Use the proper extension cord**

Keep extension cord length to a minimum. Use the following guide for choosing the proper extension cord:

- 18 gauge cord - maximum length 10 feet
- 16 gauge cord - maximum length 25 feet
- 14 gauge cord - maximum length 50 feet
- 12 gauge cord - maximum length 100 feet

## **Use approved hoses**

Use hoses that are approved for refrigerant removal. These hoses must provide a shut-off device within 12 inches of the ends.

## **Use caution when connecting or disconnecting hoses**

Improper usage may result in refrigerant burns (frostbite). If a significant refrigerant leak occurs, proceed immediately to a well-ventilated area.

## **Avoid dangerous environments**

Although the unit can be used outdoors, we do not recommend operation in the rain, or in wet locations. Secure the unit when working above floor level. This equipment should not be used in the vicinity of spilled or open containers of flammable materials.

## **Ventilation requirements**

This equipment should be used in a location with mechanical ventilation that provides at least 4 air changes per hour, or the equipment should be located at least 18 inches above the floor.

## **Disconnect unit before servicing**

Electrical shock hazard may be present when the unit is disassembled.

## **Avoid accidental starting**

Make sure the power switch is in the OFF position before plugging this equipment into an AC power source.

## **Use recommended accessories**

Follow the instructions that accompany all accessories. Improper use of accessories may damage the equipment or create a hazard.

## **Repair damaged parts**

Do not operate the unit with a defective part. Repair unit to proper operating conditions.

# Operational Safety

---

 **WARNING:** Inhalation of high concentrations of refrigerant vapors is harmful and may cause heart irregularities, unconsciousness, or death. Deliberate inhalation of refrigerants is extremely dangerous and may cause death. Vapor reduces the oxygen available for breathing and is heavier than air. Decomposition products are hazardous. Liquid contact can cause frostbite. All refrigerant containers, equipment, and hoses are under high pressure.

- Avoid breathing high concentrations of vapors.
- Use with sufficient ventilation to keep operator exposure below recommended limits, especially in enclosed and low lying areas.
- Avoid contact of liquid with eyes and prolonged skin exposure.
- Wear safety goggles and protective gloves.
- Do not apply open flame or heat unit above 125 °F.
- Do not allow refrigerants to contact open flame. Decomposition will occur. Inhalation of decomposition is harmful.

**FIRST AID:** If high concentrations of refrigerant vapors are inhaled, immediately remove the person(s) to fresh air. Keep calm. If not breathing, give artificial respiration. If breathing is difficult, give oxygen. Call a doctor. Do not give epinephrine or similar drugs.

**EYE:** In case of liquid contact, immediately flush eye with water. Seek medical attention.

**SKIN:** Flush with water. Treat for frostbite by gently warming the affected area.

 **CAUTION:** All refrigerant hoses, recovery tanks, refrigerant lines, the STINGER unit, and other vessels containing refrigerants should be handled at all times as if under high pressure.

# Description of Features

---

1. Inlet Gauge	Displays the inlet/suction pressure of the system being evacuated.
2. Purge Valve	This valve determines what function the STINGER performs. This valve is UP during recovery operations and DOWN for purging and liquid push-pull operations.
3. Inlet Port Valve	Opens or closes the inlet port. Points UP (open) for all recovery operations and points DOWN for purging operations.
4. Inlet Port	Refrigerant hose connection for incoming refrigerant.
5. Outlet Gauge	Displays the outlet/discharge pressure.
6. Outlet Port Valve	Opens or closes the outlet port. Points UP when it is open, and to the left when CLOSED.
7. Outlet Port	Refrigerant hose connection for outgoing refrigerant.
8. Circuit Breakers	Protects the STINGER from over current.
9. 80% Tank Full Shutoff Cord (Optional)	<p>This optional accessory connects to a DOT recovery cylinder's overfill sensor and automatically shuts the STINGER off when the recovery cylinder reaches 80% of its liquid-fill limit.</p> <p><b>Note:</b> If this option is installed, the STINGER will not operate unless it is connected to a recovery cylinder with a compatible level-float switch. If the recovery cylinder does not have a float switch, then a shorting cap must be installed on the shutoff cord.</p>
10. Power Cord	Plugs into an appropriate AC outlet. Note that 220 VAC units are equipped with a male IEC 60320 plug that requires a customer supplied power-cord adapter that conforms to local electrical codes.
11. Power Switch	When in the ON position, this switch starts the recovery operation by turning ON the compressor.
12. Storage Pocket	This heavy-duty storage pocket is used to store the Operations Manual, the Warranty Card and the Original Invoice. These items should be kept with the unit at all times.

# Description of Features Continued

---

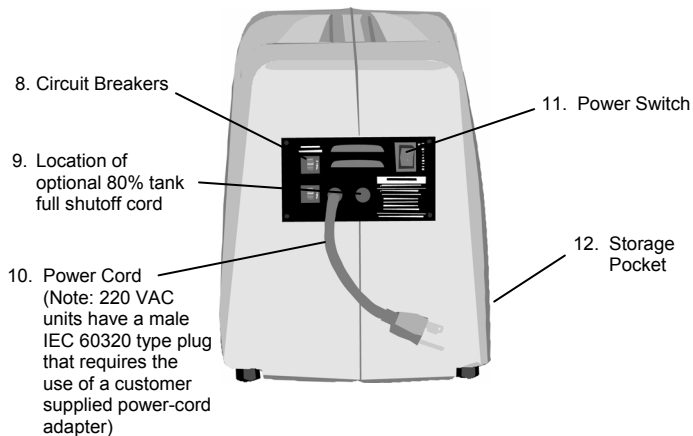
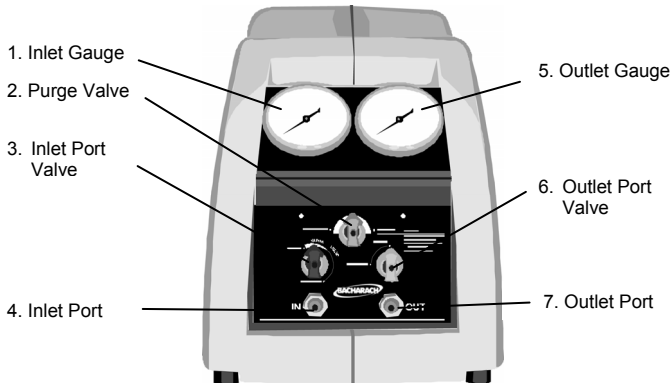



# Vapor/Liquid Recovery Operations

---

Perform the following steps when recovering refrigerant that is either in vapor or liquid form.

**Note:** Refer to “R-410A Recovery – Special Notes” on Page 14 when recovering R-410A.

1. Turn off all electrical or mechanical power to the refrigerant device to be evacuated.
2. Make proper hose connections. Connect refrigerant hoses to recovery cylinder, STINGER, and A/C system as shown on Page 10. When possible, use a manifold-gauge set to recover refrigerant from both the high- and low-side service ports. This will speed up the recovery rates.

 **CAUTION:** If the 80% tank full shutoff cord is *not* used, then use a scale to monitor the refrigerant level in the recovery cylinder in order to prevent overfilling.

 **CAUTION:** When recovering R-410A, you must use a recovery cylinder approved for use with R-410A. ***Standard recovery cylinders with 350 psi working pressures are not approved for use with R-410A.***

3. Turn the inlet and outlet valves to their “OPEN” position, and the PURGE valve to its “RECOVER” position. Open the liquid valve on the DOT recovery tank.
4. Use the rear mounted power switch to turn ON the STINGER. The compressor will now begin to recover refrigerant.

**Note:** When recovering liquid, in rare instances a “knocking” sound may come from the compressor. This indicates that too much liquid is entering the compressor. The inlet valve must be regulated (closed) until this knocking sound stops, otherwise compressor damage could occur. Pumping liquid when the compressor is knocking will damage the compressor, reduce the compressor life, **and void the compressor's warranty**. This condition is rare and should not occur under normal recovery operations.

5. Proceed with the recovery process until the system pressure shows a vacuum. Turn OFF the STINGER for a minimum of 5 minutes; after which, determine the amount of refrigerant remaining in the system. Repeat this step until system pressure is below mandatory EPA levels.
6. Purge the STINGER as follows:
  - a. Turn OFF the STINGER.
  - b. Turn the inlet and purge valves to their “PURGE” position (both pointing DOWN), and the outlet valve to its “OPEN” position (pointing UP).
  - c. Turn ON the STINGER and monitor the inlet gauge. The purge operation is complete when the inlet pressure gauge shows a vacuum.

# Standard Recovery Hose Connections

## IMPORTANT NOTES FOR LIQUID RECOVERY

**Do not pump virgin refrigerant with the STINGER.** Unlike recovered refrigerant, virgin refrigerant does not contain oil. Pumping virgin refrigerant through the STINGER will remove all lubrication from the compressor bearings, resulting in premature bearing failure. Use the liquid push-pull method or the liquid-pull method to transfer large amounts of liquid refrigerant (virgin or dirty).

**Attention:** You must use an IN-LINE FILTER when recovering liquid. Contaminants (particularly from the bottom of recovery cylinders) can enter the STINGER and become lodged in the valve seats causing damage and resulting in leaks. Any standard in-line filter will work.

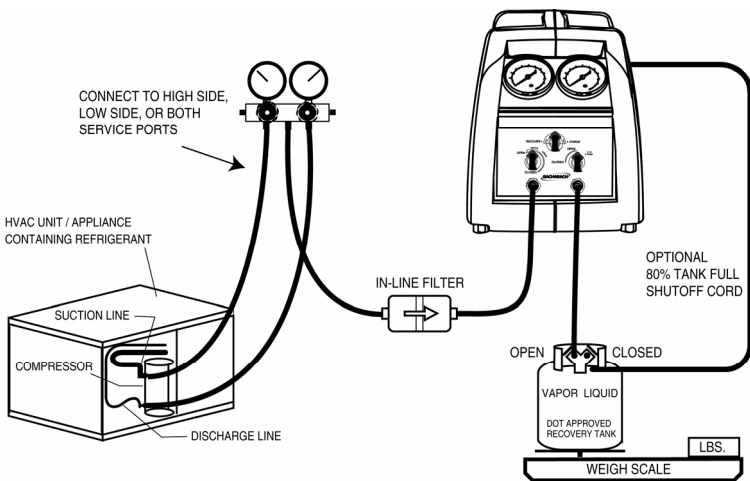

# Liquid Push-Pull Recovery Operations

---

**Attention:** Before attempting liquid push-pull recovery operations, please review this page.

A scale or liquid-sight glass can be used to determine when all the liquid is recovered. The STINGER will not pull a vacuum using the liquid push-pull recovery operation. To finish the recovery operation, you must perform vapor recovery operations as described on Page 9.

## **GUIDLINES:**

If any of the following conditions are present in the system being evacuated, the liquid push-pull operations may not be practical and vapor recovery operations should be performed.

- ✓ The equipment contains less than 20 lbs of refrigerant.
- ✓ The equipment is a heat pump or other system with refrigerant flow that would prevent you from isolating the liquid.
- ✓ Equipment has an accumulator between the service ports used in the liquid recovery process.
- ✓ Liquid refrigerant migration has occurred and the location of the liquid is unknown.
- ✓ The refrigerant tubing design on the equipment does not allow for a solid column of liquid refrigerant to be formed.

## **STEPS:**

The liquid push-pull recovery method requires the use of a third hose. In addition, a sight-glass is useful for determining when all of the liquid has been pushed out of the system. After all the liquid has been pushed out, you will need to reconfigure the hoses for vapor recovery since the liquid push-pull recovery method does not pull a vacuum on the system.

1. Remove power from the refrigerant device to be evacuated.
2. Make proper hose connections for liquid push-pull recovery as shown in the diagram on Page 12.

 **CAUTION:** If the 80% tank full shutoff cord is *not* used, then use a scale to monitor the refrigerant level in the recovery cylinder in order to prevent overfilling.

 **CAUTION:** When recovering R-410A, you must use a recovery cylinder approved for use with R-410A. ***Standard recovery cylinders with 350 psi working pressures are not approved for use with R-410A.***

3. Turn the inlet and outlet valves to their "OPEN" position and the PURGE valve to its "PURGE" position. **Note:** The "PURGE" position bypasses the condenser, optimizing the push-pull flow rate.

# Liquid Push-Pull Operations Continued

4. Open both the vapor and liquid valves on the DOT recovery tank.
5. Turn ON the STINGER. The compressor will begin to "pull" vapors from the cylinder and "push" the liquid out of the system and into the recovery cylinder.
6. If a sight-glass is being used, you should watch it to determine when all of the liquid has been removed from the system.
7. The liquid push-pull recovery method will not pull a vacuum in the system. You must turn OFF the STINGER and reconfigure the hoses for vapor recovery operations as described on Page 9.

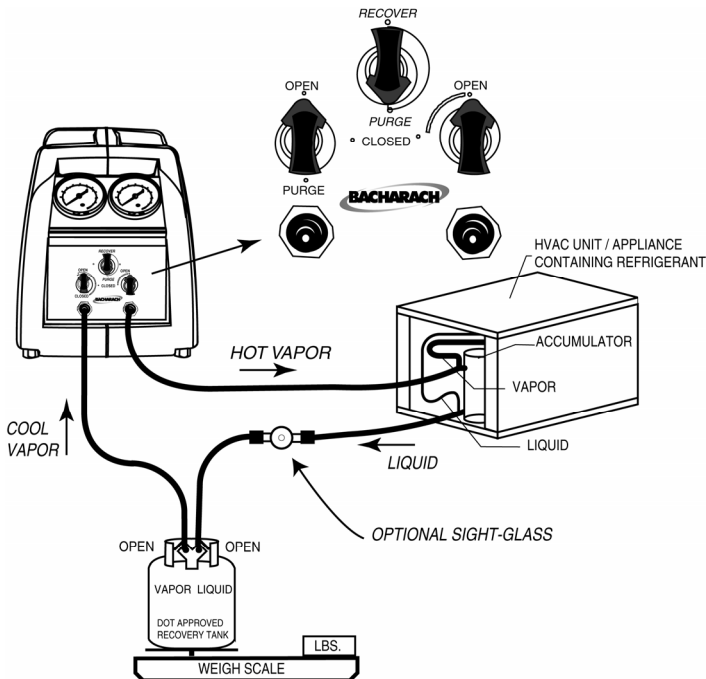

# Liquid-Pull Recovery / Charging Method

**Do not pump virgin refrigerant with the STINGER.** Unlike recovered refrigerant, virgin refrigerant does not contain oil. Pumping virgin refrigerant through the STINGER will remove all lubrication from the compressor bearings, resulting in premature bearing failure. Use the liquid push-pull method or the liquid-pull method to transfer large amounts of liquid refrigerant (virgin or dirty).

The liquid-pull method is used to move a large amount of liquid refrigerant without the refrigerant passing directly through the STINGER. The virgin refrigerant is pulled directly into the system being charged. The STINGER keeps the pressure low in the system by removing vapor. For every pound of vapor removed, as much as 25 pounds of refrigerant may be transferred. This method can be used for either virgin refrigerant or really dirty refrigerant.

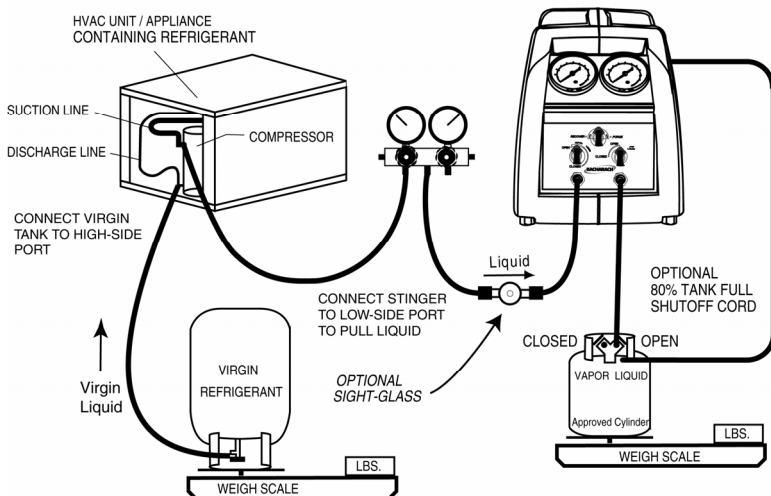

# R-410A Recovery – Special Notes

R-410A is a replacement refrigerant for R-22. Its physical properties, however, are much different than R-22. R-410A has a higher vapor pressure and is more dense than R-22. These characteristics make recovering R-410A more difficult by putting more of a load on the compressor. Please follow the instructions below to ensure trouble-free R-410A recovery operations.

**Note:** Hose connections are the same for recovering R-410A. Connect hoses as shown in the vapor recovery diagram below.

Under normal operating conditions the STINGER can recover R-410A just like R-22. Under certain conditions, however, because of R-410A's higher vapor pressure and density, you will have to take the following precautions:

**⚠ CAUTION:** USE ONLY DOT RECOVERY CYLINDERS APPROVED FOR USE WITH R-410A. Overfilling or over-pressurizing your recovery cylinder is extremely dangerous!

**WHEN RECOVERING VAPOR:** If the STINGER sounds like it is overloaded either by slowing down or by making a “knocking” sound, reduce the inlet pressure by closing or “throttling” the inlet valve until the STINGER begins to run normally.

**WHEN RECOVERING LIQUID:** If a loud knocking noise occurs, the inlet pressure on the STINGER should be throttled back by slowly closing the inlet valve until the knocking noise stops. This action will prevent compressor damage.

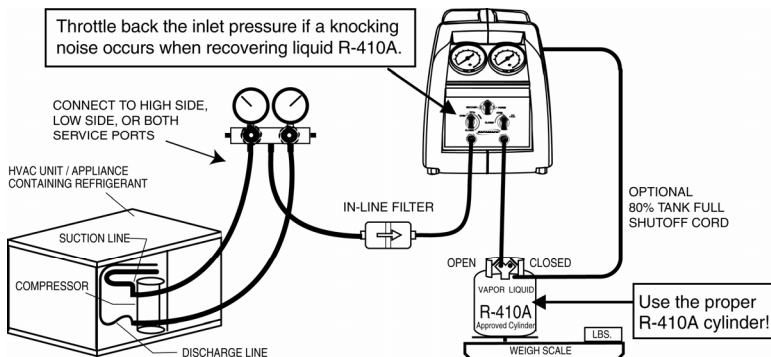

# Purging the STINGER

---

The STINGER is equipped with a pump-down purge valve that allows the technician to pump down or evacuate the STINGER before proceeding to the next recovery operation. This procedure not only eliminates cross contamination, but also conserves refrigerant. Follow the steps below to ensure your pump-down operation is performed correctly.

During the purge operation the entire STINGER is pulled into a vacuum, leaving no more than 0.1 ounce of refrigerant in the unit.

## STEPS:

1. After recovery operations are complete, turn OFF the STINGER and then turn the inlet, purge, and outlet valves to the following positions:

**It is important to turn the valves in the following order to ensure that the compressor equalizes properly.**

FIRST Turn the inlet valve to its "PURGE" position (pointing DOWN).

SECOND Turn the purge valve to its "PURGE" position (pointing DOWN).

THIRD Turn the outlet valve to its "OPEN" position (pointing UP).

2. Turn ON the STINGER and allow the unit to run until its inlet gauge indicates that there is an adequate vacuum present.
3. Turn OFF the STINGER, and then turn the outlet valve to its "CLOSED" position. Also, close the vapor and liquid valves on the DOT recovery tank.

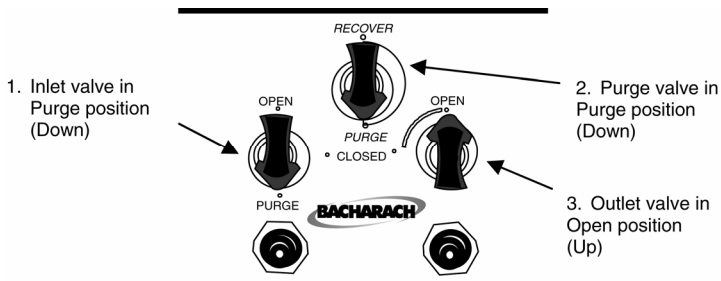

# DOT Recovery Cylinder Safety

---

 **WARNING!** This unit is capable of over-pressurizing a DOT recovery cylinder. Ensure that you are using the proper DOT recovery cylinder for the refrigerant that you are recovering. ***R-410A is capable of pressures exceeding 600 psi.***

Typical DOT recovery cylinders are rated at 350 psi with a pressure relief set at 550 psi. ***These cylinders should not be used with R-410A!*** Only cylinders rated at 400 psi with a pressure relief set at 600 psi should be used to recover R-410A. Failure to use the proper cylinder can be extremely dangerous.

If your STINGER is equipped with the optional 80% tank full shutoff cord, connect this cord to a DOT recovery cylinder's float switch. This cord connection will automatically shut OFF the STINGER when the recovery cylinder reaches 80% of its liquid-full limit. It is recommended that you use this cord for added safety.

If your STINGER is not equipped with an 80% tank full shutoff cord, or if you are using a recovery cylinder that does not have a float switch, ***then you must use a scale to prevent overfilling the cylinder.***

**Note:** If the 80% tank full shutoff cord is present, but not being used, then a shorting cap must be installed on the shutoff cord in order for the STINGER to operate.

Bacharach uses and recommends the Air Conditioning & Refrigeration Institute's (ARI) Guideline K for the safe filling and handling of used refrigerant. This Publication is available from ARI at <http://www.ari.org>.

The following information provides the safe fill weights for used refrigerant based on the size of the container and is in accordance with Guideline K:

WATER CAPACITY	NET REFRIGERANT WEIGHT	GROSS CONTAINER WEIGHT (APPROX.)
30 lbs	24 lbs	38 lbs
50 lbs	40 lbs	59 lbs
95 lbs	76 lbs	118 lbs
145 lbs	98 lbs	153 lbs
238 lbs	190 lbs	274 lbs



# Recovery Tips

- Use the shortest hoses possible. Long hoses increase the recovery time. Remove all restrictions in the hoses. Hoses with ball valves on the ends are better than hoses that are self-sealing. Remove Schrader core valves when possible from service ports.
- Always identify the refrigerant you are recovering. This will minimize cross contamination and help you plan for the amount of refrigerant you will be recovering.
- Always pump liquid out of the system first, and then recover the remaining vapors. This will significantly speed up recovery rates.
- With large amounts of refrigerant, use the liquid push-pull recovery method. This method is three times faster than recovering liquid directly. Refer to the liquid push-pull instructions on Page 11.
- When possible, recover from both the high and low side service port on the refrigeration system. This will speed up the recovery rate.
- Use an in-line filter to prevent contaminants from entering the STINGER.
- If the STINGER has the optional 80% tank full shutoff cord installed, connect this cord to the recovery cylinder's float switch. If the cylinder does not have a float switch, then be sure to install a shorting cap on the shutoff cord; otherwise, the STINGER will not operate.

**Note:** Although using a manifold gauge set will speed up the recovery process, a manifold gauge set is not required.

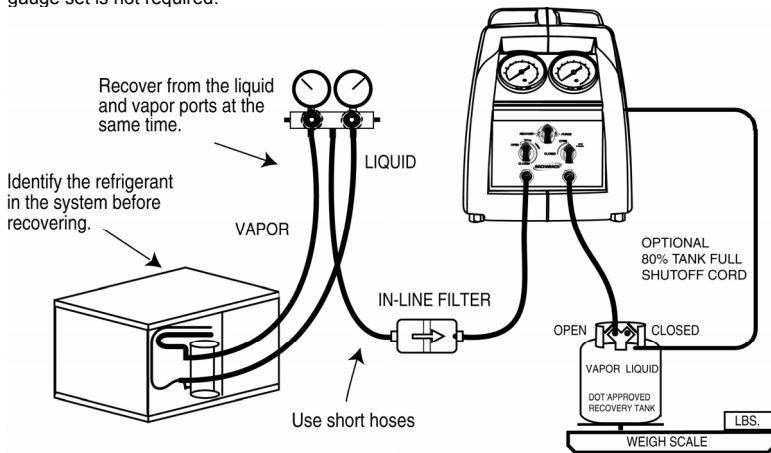

# Troubleshooting

PROBLEM	CAUSE	ACTION
Unit will not start – Fan does not run; compressor does not start	Power Cord not attached No voltage at receptacle	Attach Power Cord Verify voltage at job site
Unit will not start – Fan starts and runs; compressor starts but will not stay on	Optional 80% tank full shutoff cord not connected to tank  Float switch in tank is open  Tank is full and float switch has opened	Connect cord  Check tank switch with multi- meter  Change tanks or short cord and use scale
Cooling fan runs but compressor will not start	Circuit breaker has opened  Discharge pressure too high  HP Switch has opened  Electronics failure in motor, or on printed circuit board	Identify cause of breaker activation, rectify and reset  Reduce pressure and rotate Purge Valve to "Purge" and back to "Recover"  Reduce pressure  Factory service required
Compressor starts but cuts out within a few minutes; pressure indication on HP gauge is high	Purge valve is in "Purge" position during recovery and HP switch activates  Discharge valve is not open and HP switch activates  Recovery tank valve not open  Blocked discharge hose  Air in system/tank	Rotate Purge Valve to "Recover"      Rotate Discharge Valve to "Open" position  Open tank valve  Check and clear blockage  Bleed air from system/tank
Compressor stops intermittently	Vapor pressure of refrigerant in tank is close to HP trip point	Reduce tank temperature
Unit overheats	Excessive suction pressure due to high ambient temperature	Reduce inlet pressure below 80 psi by throttling the inlet valve.
Recovery process too slow	Head pressure too high  System refrigerant iced up    Restriction in hoses or manifold gauge set  Compressor seals are worn	Reduce tank temperature or change tanks  Throttle gauge manifold valves and discharge valve to reduce pressure differential between LP and HP gauges  Interrupt process and allow ice to dissipate  Check and clear restriction  Rebuild compressor – check with wholesaler for assistance

# Schematic Diagrams

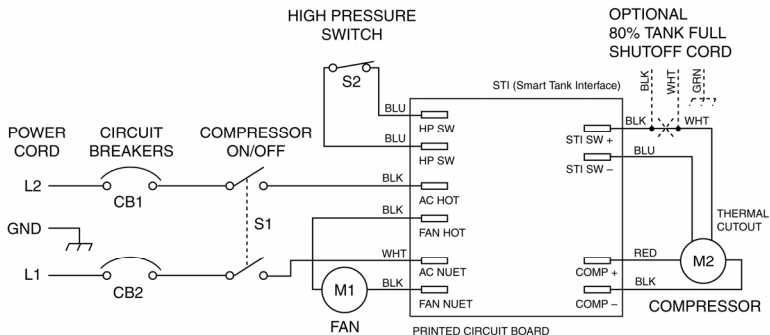

SCHEMATIC - 110/120 VAC UNITS

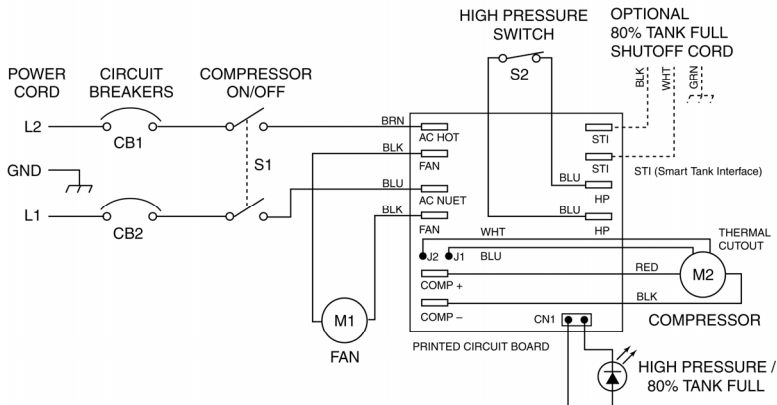

SCHEMATIC - 220 VAC UNITS

# STINGER Parts List

---

See STINGER Exploded View on Page 21.

Item No.	Part Number	Description	Qty
1	2045-0620	Compressor (110/120 VAC)	1
1	2045-0720	Compressor (220 VAC)	1
2	2023-0100	Manifold	1
3	2014-0310	High Pressure Switch, 550 psi	1
4	2013-0090	Fan, 4", 110/120 VAC	1
4	2013-0040	Fan, 4", 220 VAC	1
5	2043-0140	Plastic Case, Left	1
6	2043-0150	Plastic Case, Right	1
7	2063-0150	Gauge, Low Pressure	1
8	2063-0160	Gauge, High Pressure	1
9	2015-0140	Printed Circuit Board (110/120 VAC)	1
9	2015-0160	Printed Circuit Board (220 VAC)	1
10	2043-0160	Screen Guard, Condenser	1
11	2043-0130	Screen Guard, Fan	1
12	2014-0030	Circuit Breaker, 10 amp	2
13	2013-0055	Compressor Fan Blade	1
14	2043-0170	Vinyl Storage Pouch	1
15	2090-0059	Power Switch	1
16	2043-0120	Plastic Knob, Outlet, Red	1
17	2043-0100	Plastic Knob, Inlet, Blue	1
18	2043-0110	Plastic Knob, Black	1
19	2051-0660	Plastic Caps w/ Retainer <sup>3</sup> / <sub>8</sub> "	2
20	2051-1680	Screws For Knobs	3
21	2022-0030	Fitting, Cylinder Head Elbow	2
--	2079-1130	Instruction Manual	1

# STINGER Exploded View

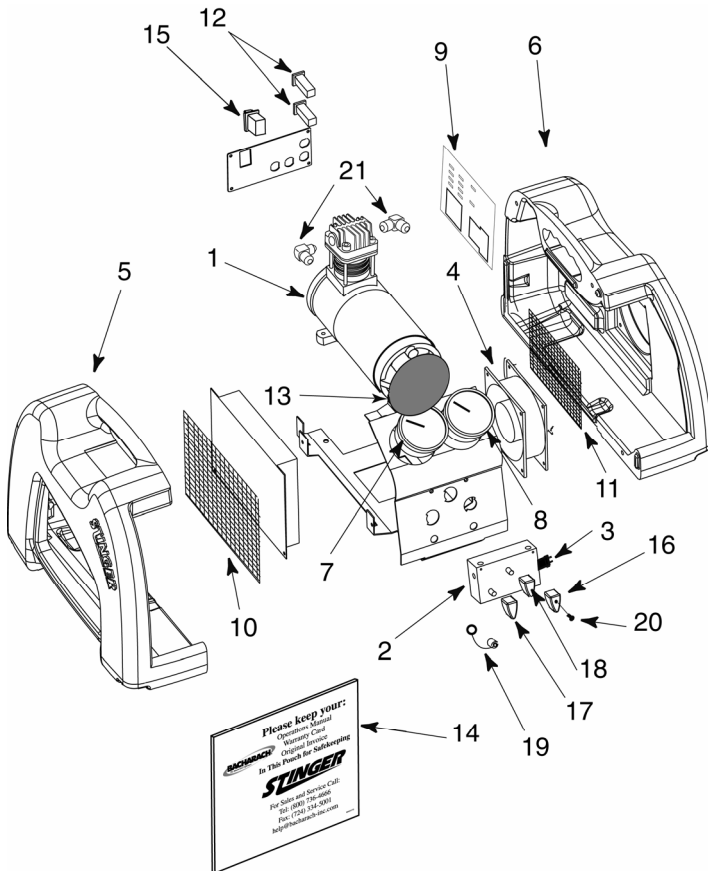

# Compressor Parts List

---

See Compressor Exploded View on Page 23.

Part No.	Item	Description	Qty
2081-0410	1	Motor Shaft Head Bearing	1
2081-0370	2	Crank Housing	1
2043-0030	3	Shaft Seal	1
2051-1900	4	Screw, Machine, M5 x 10MM	1
2081-0310	5	Piston Cup Seal Retainer	1
2043-0020	6	Piston Cup Seal	1
2081-0270	7	Piston	1
2081-0400	8	Piston Journal Bearing	1
2081-0260	9	Crank	1
2077-0940	10	Gasket	1
2081-0300	11	Crank Housing End Cover	1
2051-1920	12	Screw, Cap, M5 x 18MM	4
2081-0390	*13	Shim, 0.002"	1
2081-0420	*14	Shim, 0.003"	1
2081-0430	*15	Shim, 0.005"	1
2077-0950	16	O-Ring, #026	1
2081-0290	17	Cylinder	1
2090-0039	18	Valve Plate Assembly	1
2081-0280	19	Cylinder Head	1
2051-1910	20	Screw, Cap, M5 x 50MM	4
2090-0040	21	Motor Brushes	2
2090-0041	22	Cap, Motor Brush	2
2090-0042	--	Compressor Rebuild Kit Includes Items 4, 5, 6, 13, 14, 15, 16, 18	1

\*Any or all of these shims may be used.

# Compressor Exploded View

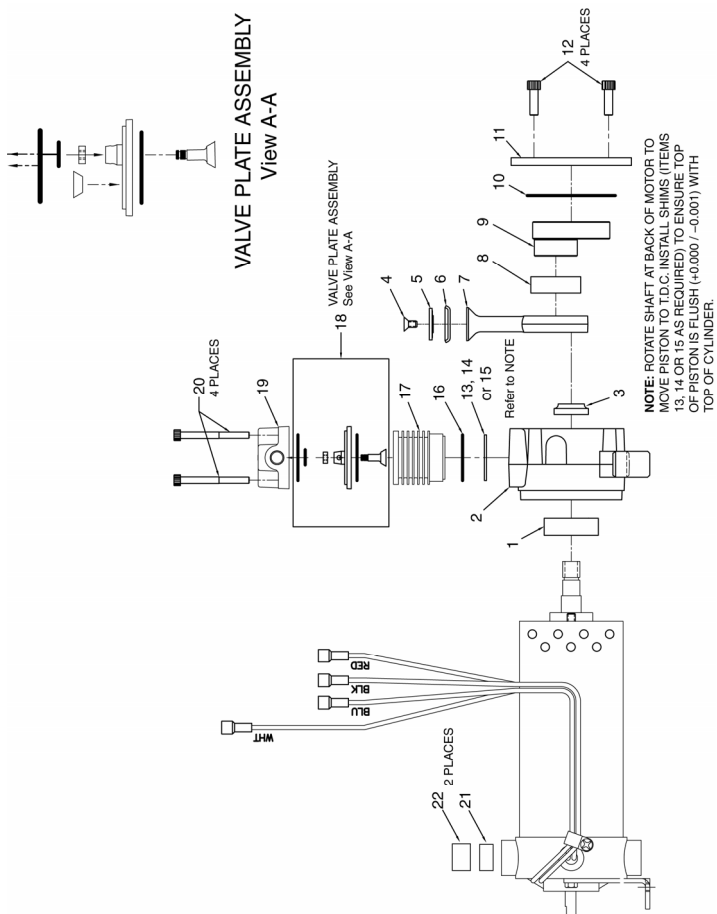

# Warranty / Repair Procedures

---

If your **STINGER** is in need of warranty service, Bacharach will repair or replace your unit for a period of one (1) year from date of purchase. Please note that the STINGER is warranted against factory defects. Parts that require replacing due to normal wear and tear or abuse are not covered under warranty. Examples of wear items include the compressor piston cup seal (P/N 2043-0020) and the motor brushes (P/N 2090-0040).

**In order to obtain warranty service, YOU MUST DO THE FOLLOWING:**

1. You have talked with our technical service department at 800-736-4666 and the problem is found to be a factory defect.
2. The wholesaler has obtained an RMA Number from Customer Service.
3. You return the unit freight prepaid to:

BACHARACH, INC.  
621 Hunt Valley Circle  
New Kensington, PA 15068

**Note:** Make sure that the RMA Number is clearly written on the outside of the shipping box or on the packing slip.

Your unit will be shipped back to you freight prepaid.

If you have any questions, please do not hesitate to call our customer service department at 800-736-4666 or e-mail us at [help@bacharach-inc.com](mailto:help@bacharach-inc.com)

We appreciate your business!