

Construction Package for Cold Formed Steel Building
Created for Claude Simon
Job Number UA OB 51202310



Table Of Contents

Anchor Bolt Layout2
Girt Layout 4
Sheeting Layout8

Construction Package Notes

This construction package is to be used in conjunction with the created order for the job. All lengths and piece marks of materials in this package will correspond to an item for the order. For example, on the Sidewall A girt layout, there will likely be an item with a piece mark of SGA1. This will correspond to a line item in the order with the piece mark of SGA1.

All applicable drawings illustrations in this construction package are exterior views, and all components are drawn as if viewed from the outside of the building.

All drawings in this construction package are for reference only, and are to be used to supplement the engineering drawings. If any discrepancies occur, the engineering plans will always take precedence.

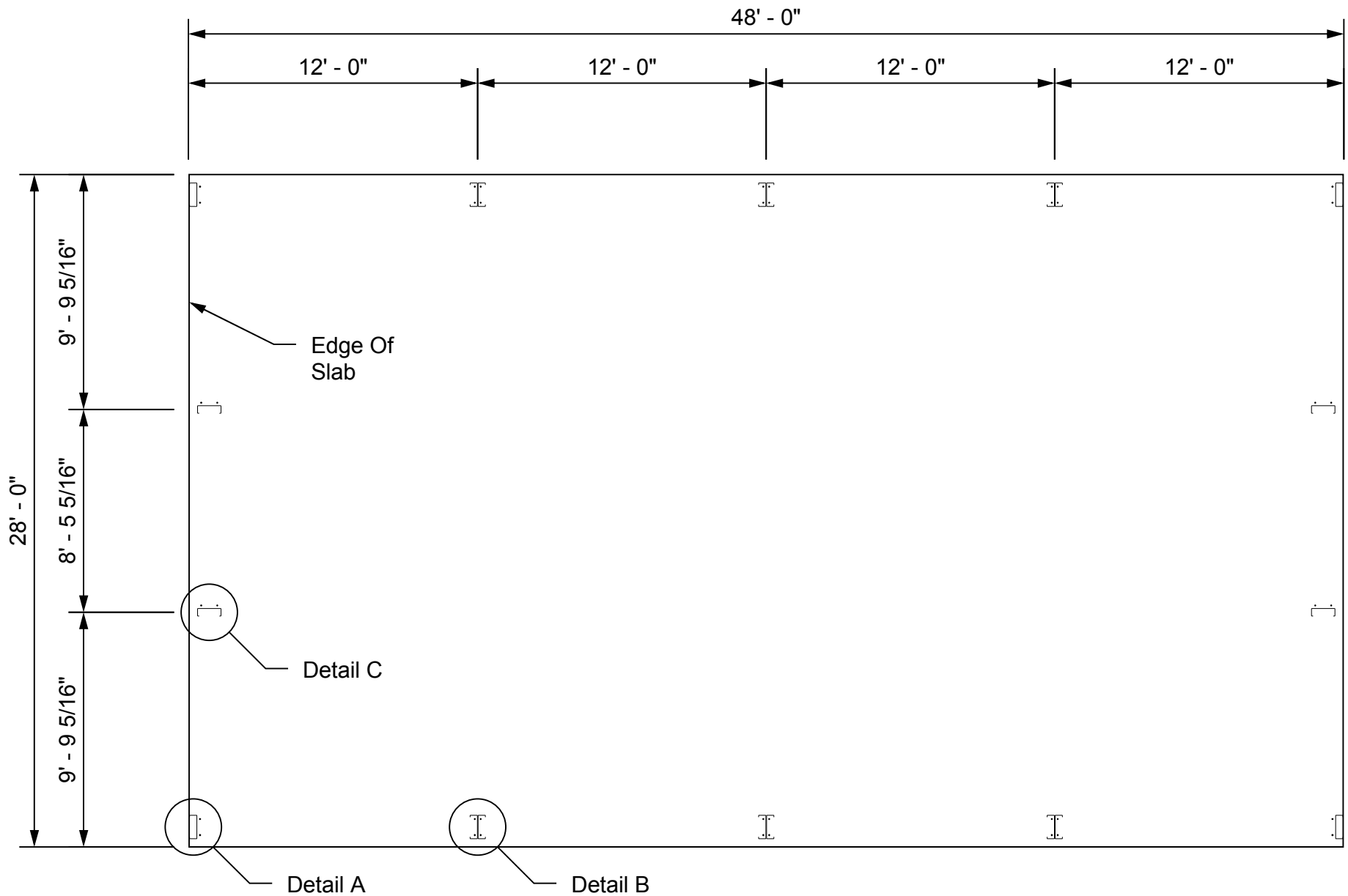

This illustration is for reference only, and is to be used to supplement the engineering drawings. If any discrepancies occur, the engineering plans will always take precedence.



Anchor Bolt Plan

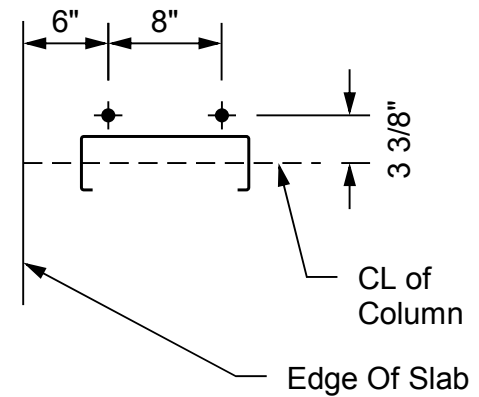
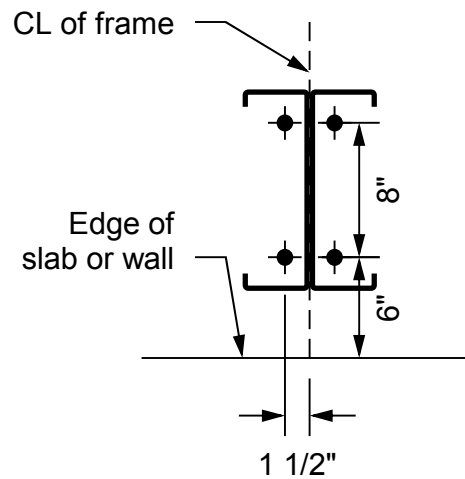
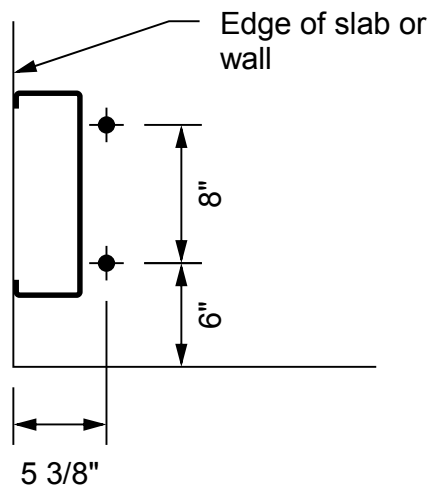

A

Corner Column

B

Sidewall Column

C

Endwall Column



This illustration is for reference only, and is to be used to supplement the engineering drawings. If any discrepancies occur, the engineering plans will always take precedence.

Anchor Bolt Plan

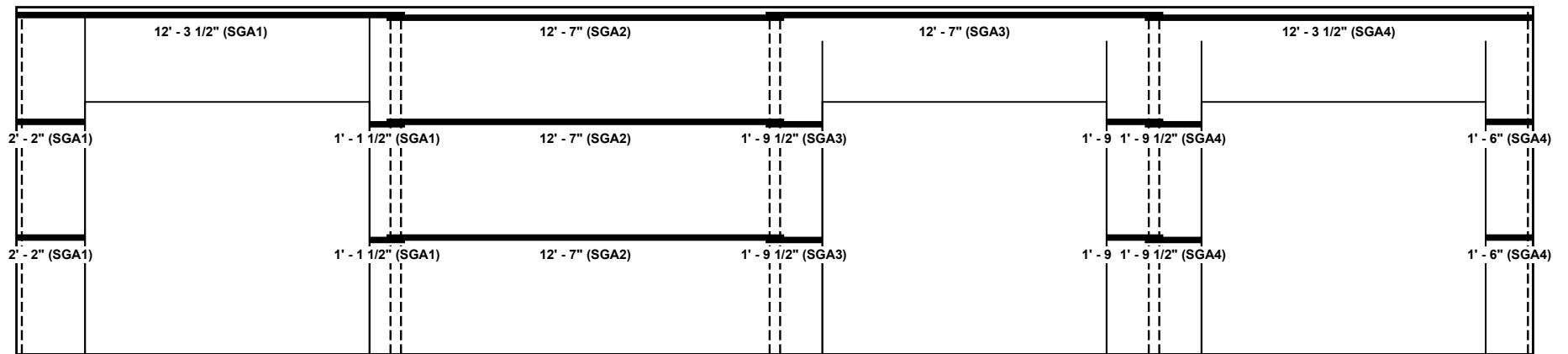

This illustration is for reference only, and is to be used to supplement the engineering drawings. If any discrepancies occur, the engineering plans will always take precedence.



Sidewall A Girt Layout

12' - 3 1/2" (SGB4)			12' - 7" (SGB3)			12' - 7" (SGB2)			12' - 3 1/2" (SGB1)		
12' - 3 1/2" (SGB4)			12' - 7" (SGB3)			12' - 7" (SGB2)			12' - 3 1/2" (SGB1)		
4' - 6" (SGB4)		4' - 9 1/2" (SGB4)	8' - 5 1/2" (SGB3)	1' - 1 1/2" (SGB3)	12' - 7" (SGB2)	1' - 1 1/2" (SGB1)		8' - 2" (SGB1)			



This illustration is for reference only, and is to be used to supplement the engineering drawings. If any discrepancies occur, the engineering plans will always take precedence.

Sidewall B Girt Layout

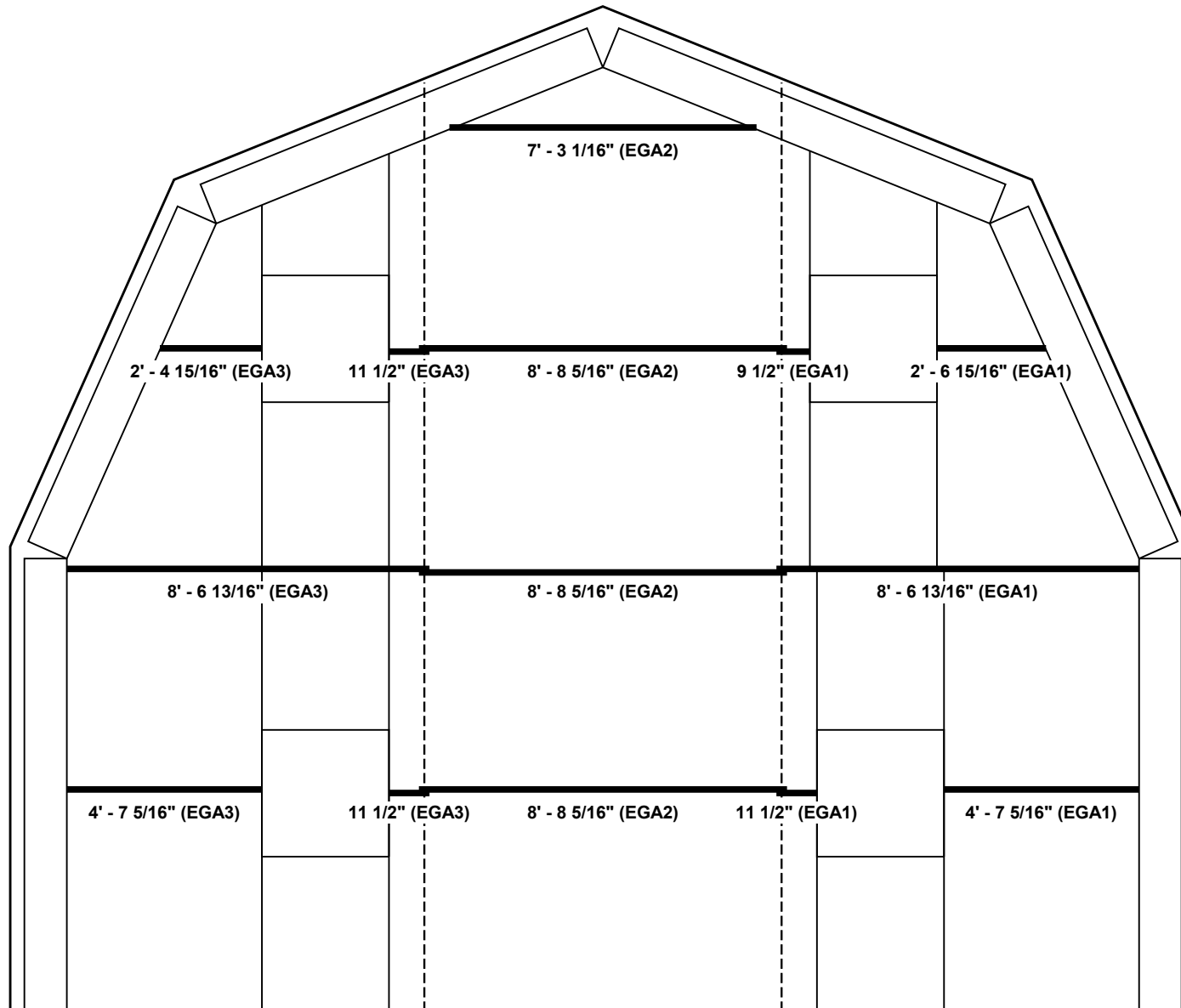

This illustration is for reference only, and is to be used to supplement the engineering drawings. If any discrepancies occur, the engineering plans will always take precedence.



Endwall A Girt Layout

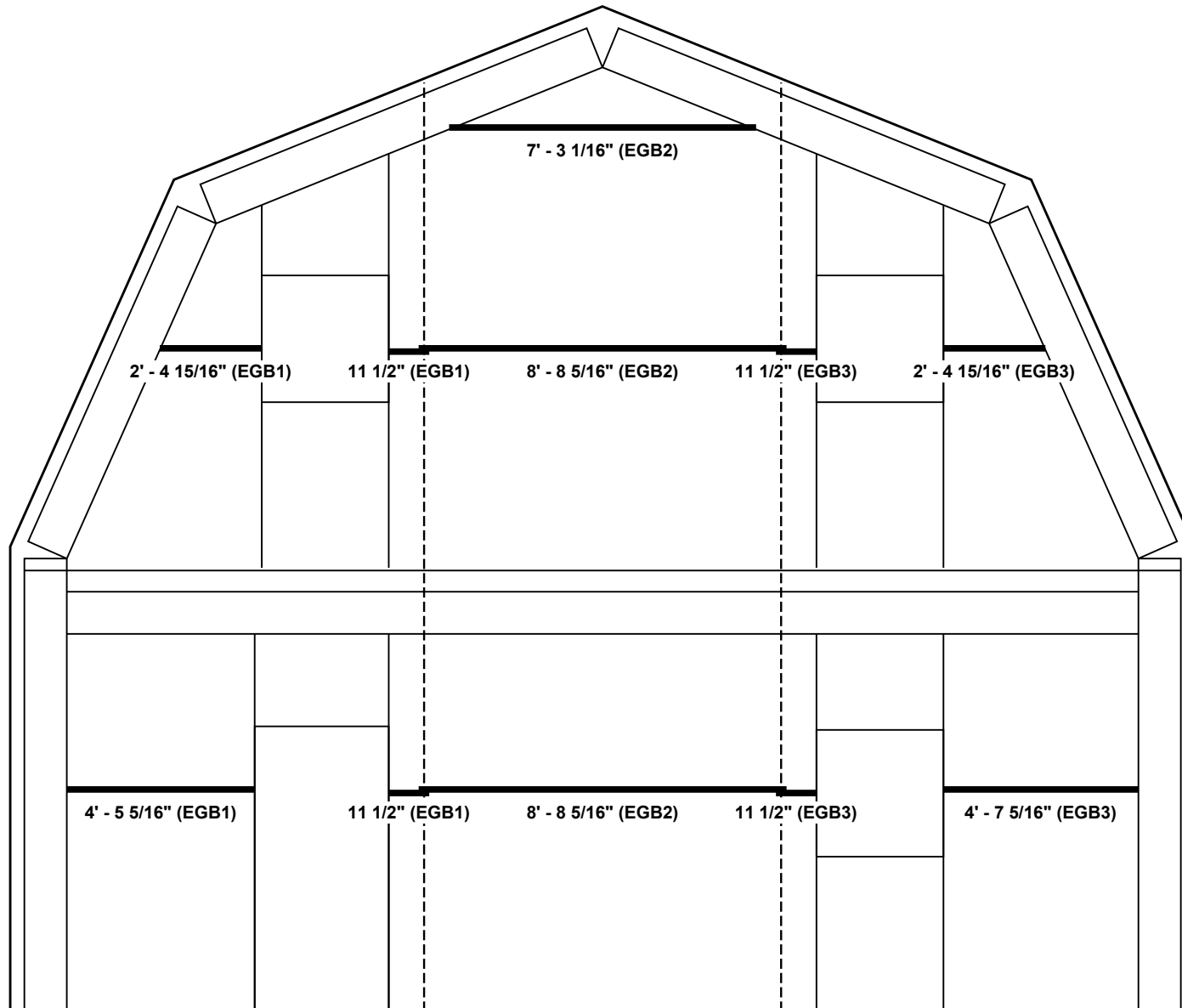

This illustration is for reference only, and is to be used to supplement the engineering drawings. If any discrepancies occur, the engineering plans will always take precedence.



Endwall B Girt Layout

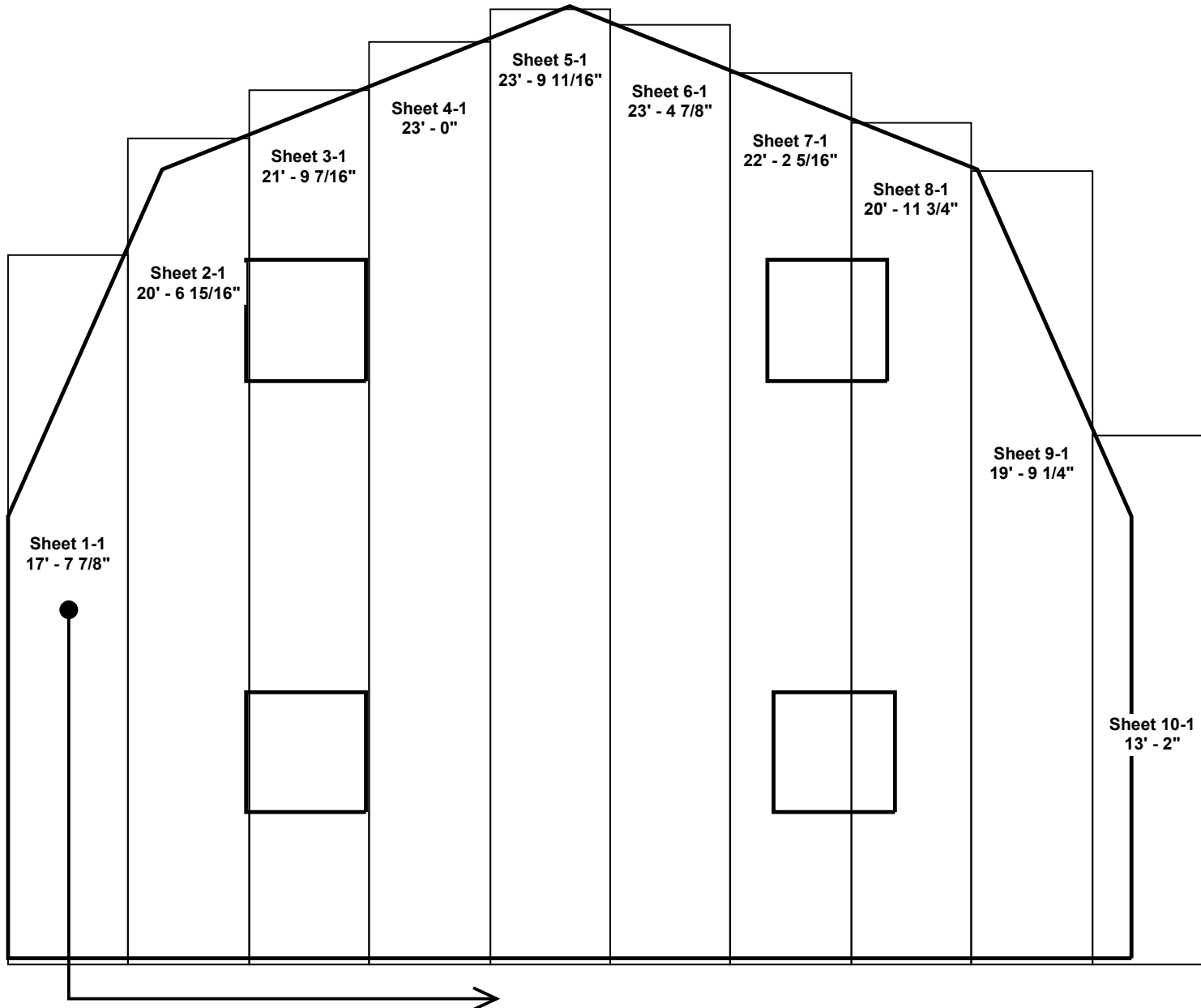

Showing How This Sheet and moves across the wall

Endwall A Sheeting Layout

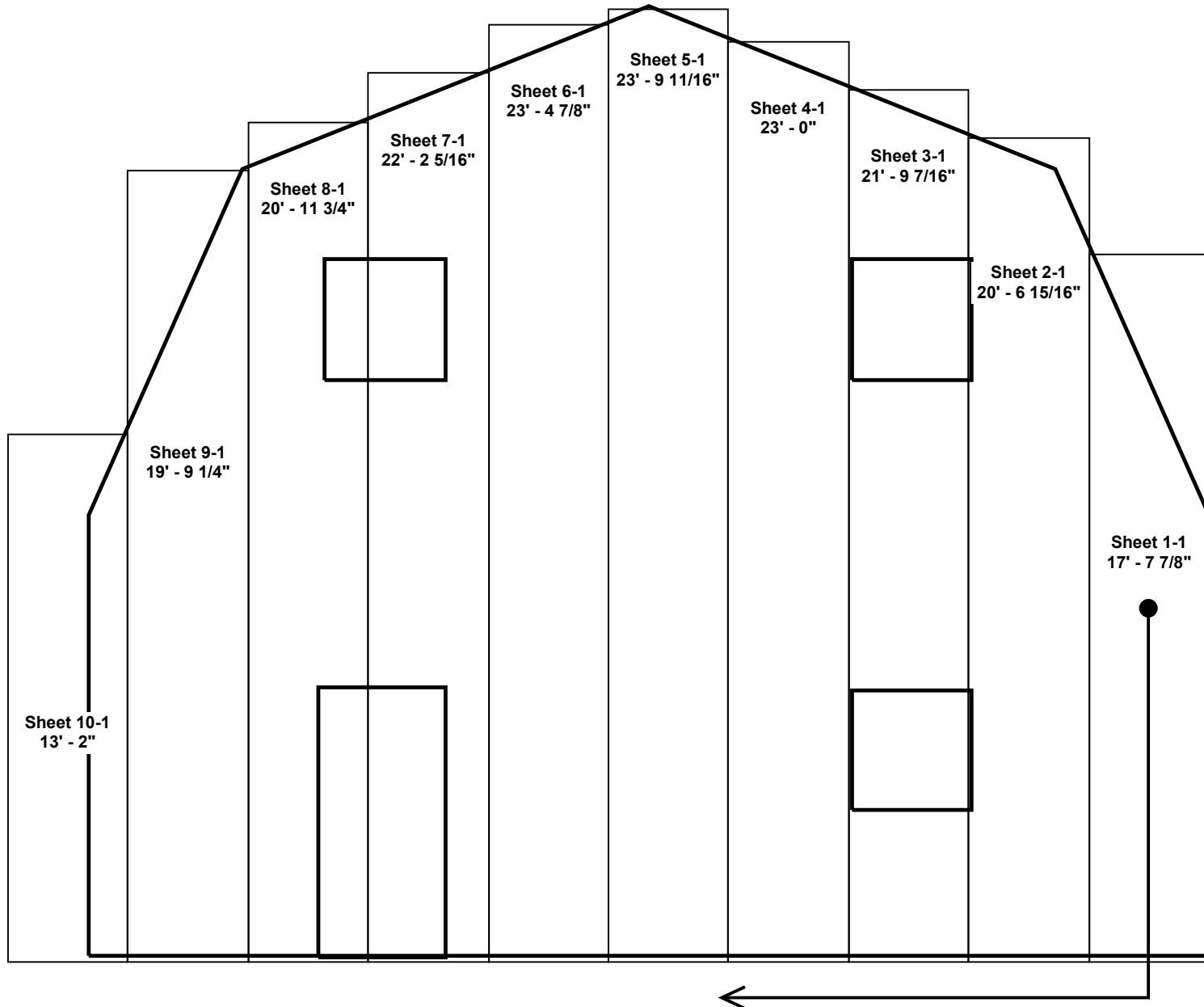

Endwall B Sheeting Layout

Sheeting starts with this sheet
and moves across the wall

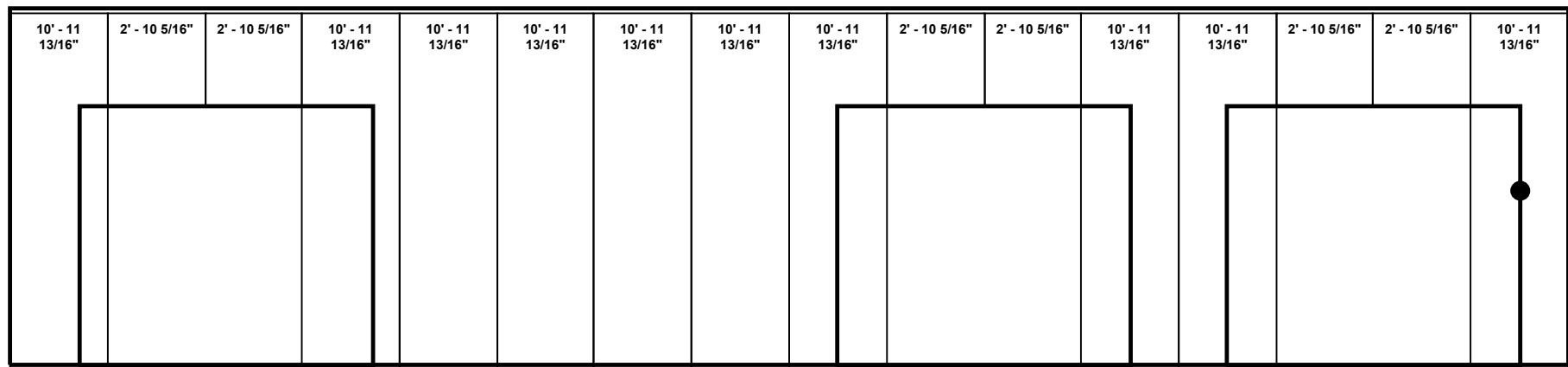

←
Sheeting starts with this sheet
and moves across the wall



Sidewall A Sheeting Layout

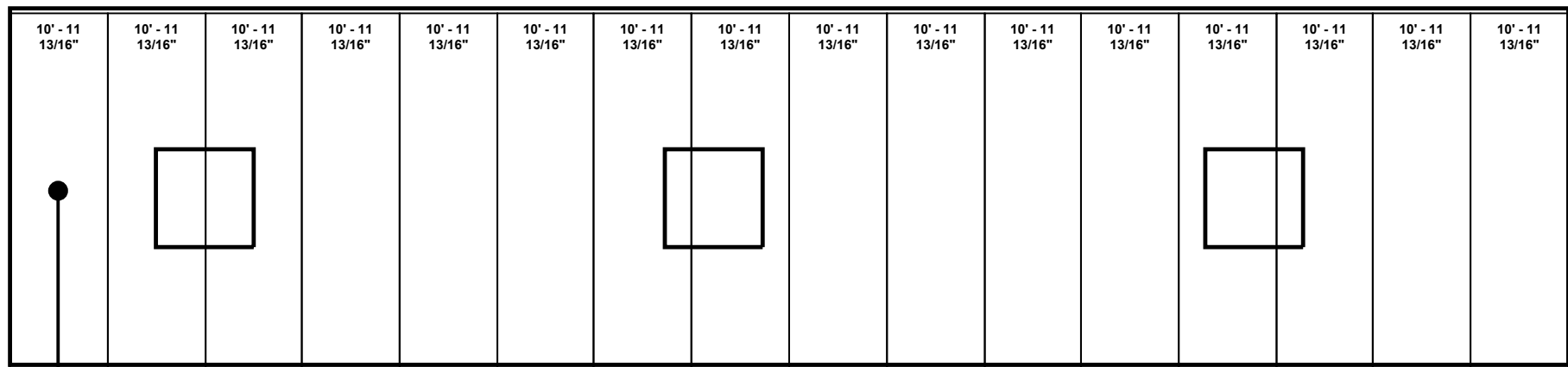

**Sheeting starts with this sheet
and moves across the wall**



Sidewall B Sheeting Layout